

## Elbow cable gland

21.7xxPAzzzz

Pressure screw	Polyamide PA6 GF25
Washers	Steel, zinc-plated
Sealing ring	SBR/NBR, multiple perforation
Elbow	Polyamide PA6 GF25
Connecting thread	metric, as per EN 60423



Properties	
Temperature range	<ul style="list-style-type: none"> <li>for application in installation areas with small amounts of space due to construction dimensions</li> </ul> -20 °C +100 °C
Protection grade	IP55

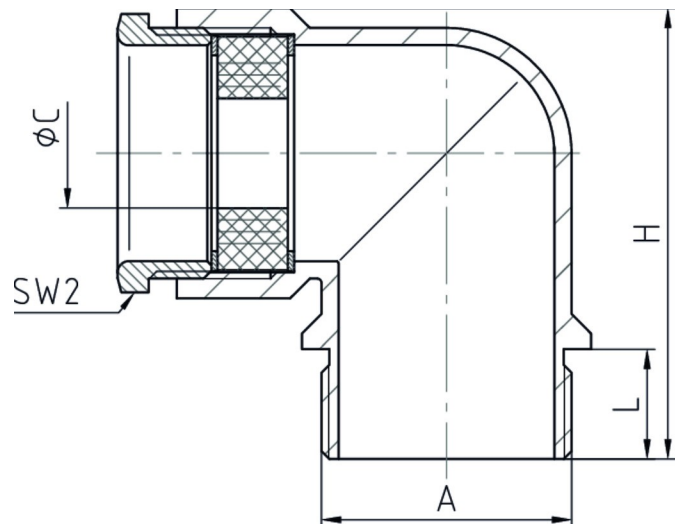

## Features

 RAL 7035

Connecting thread standard length

A	ØC	L	SW2	H	 VPE	Part No.
M16x1,5	5 - 9	12	16	38	100	21.716PA7035
M20x1,5	7 - 12	12	20	42	50	21.720PA7035
M25x1,5	8,5 - 15	12	25	48,5	50	21.725PA7035
M32x1,5	14 - 20	14	32	57,5	25	21.732PA7035

\* The maximum sealing range is dependent on type of cable and assembling.