

SERIES: SWI6-E | **DESCRIPTION:** AC-DC POWER SUPPLY**FEATURES**

- up to 6 W continuous power
- DOE Level VI, CEC, ErP Stage 2
- no load power consumption < 0.1 W
- compact size
- universal input voltage range
- over voltage, over current, and short circuit protections
- CE safety approvals
- EN 62368 compliant



| MODEL | input voltage | input frequency | output voltage | output current | output power | ripple and noise ¹ | efficiency level | | no load power consumption |
|------------|---------------|-----------------|----------------|----------------|--------------|-------------------------------|--------------------------|---------|---------------------------|
| | range (Vac) | range (Hz) | nom (Vdc) | max (A) | max (W) | max (mVp-p) | average ² (%) | 10% (%) | typ (W) |
| SWI6-3.3-E | 90 ~ 264 | 47 ~ 63 | 3.3 | 1.5 | 4.95 | 100 | 74.0 | 63.3 | 0.03 |
| SWI6-5-E | 90 ~ 264 | 47 ~ 63 | 5 | 1.5 | 7.5 | 100 | 77.5 | 66.7 | 0.05 |
| SWI6-5.9-E | 90 ~ 264 | 47 ~ 63 | 5.9 | 1.2 | 7.08 | 100 | 78.7 | 65.0 | 0.05 |
| SWI6-7.5-E | 90 ~ 264 | 47 ~ 63 | 7.5 | 1.0 | 7.5 | 100 | 80.3 | 70.1 | 0.04 |
| SWI6-9-E | 90 ~ 264 | 47 ~ 63 | 9 | 0.67 | 6.03 | 100 | 79.9 | 66.6 | 0.04 |
| SWI6-12-E | 90 ~ 264 | 47 ~ 63 | 12 | 0.6 | 7.2 | 120 | 80.9 | 65.1 | 0.05 |
| SWI6-15-E | 90 ~ 264 | 47 ~ 63 | 15 | 0.5 | 7.5 | 150 | 80.9 | 63.3 | 0.06 |

Notes: 1. At full load, nominal input, 20 MHz bandwidth oscilloscope, each output terminated with 0.1 μ F multilayer ceramic and 47 μ F low ESR electrolytic capacitors.
 2. Average efficiency is measured at 25%, 50%, 75%, and 100% load.

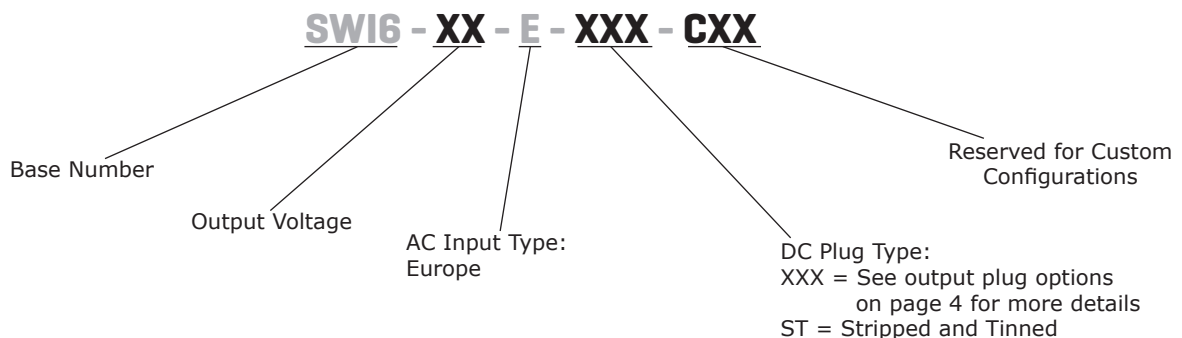
PART NUMBER KEY

INPUT

| parameter | conditions/description | min | typ | max | units |
|---------------------------|---|-----|-----|------|-------|
| voltage | | 90 | | 264 | Vac |
| frequency | | 47 | | 63 | Hz |
| current | | | | 0.19 | A |
| inrush current | at 240 Vac, full load, 25°C, cold start | | | 60 | A |
| leakage current | | | | 0.25 | mA |
| no load power consumption | | | | 0.1 | W |

OUTPUT

| parameter | conditions/description | min | typ | max | units |
|--------------|------------------------|-----|-----|-----|-------|
| regulation | | | ±5 | | % |
| hold-up time | at full load | 10 | | | ms |

PROTECTIONS

| parameter | conditions/description | min | typ | max | units |
|--------------------------|---------------------------------|-----|-----|-----|-------|
| over voltage protection | output shut down | | | | |
| over current protection | output shut down, auto recovery | | | | |
| short circuit protection | output shut down, auto recovery | | | | |

SAFETY & COMPLIANCE

| parameter | conditions/description | min | typ | max | units |
|----------------------|---------------------------------------|---------|-------|-----|-------|
| isolation voltage | input to output at 10 mA for 1 minute | | 3,000 | | Vac |
| isolation resistance | input to output at 500 Vdc | 10 | | | MΩ |
| safety approvals | EN 62368 | | | | |
| EMI/EMC | CE | | | | |
| MTBF | as per Telcordia SR-332, 25°C | 300,000 | | | hours |
| RoHS | 2011/65/EU | | | | |

ENVIRONMENTAL

| parameter | conditions/description | min | typ | max | units |
|-----------------------|------------------------|-----|-----|-----|-------|
| operating temperature | | 0 | | 40 | °C |
| storage temperature | | -20 | | 60 | °C |
| operating humidity | non-condensing | 20 | | 80 | % |
| storage humidity | non-condensing | 10 | | 90 | % |

MECHANICAL

| parameter | conditions/description | min | typ | max | units |
|------------|------------------------|-----|-----|-----|-------|
| dimensions | 56 x 28 x 60 | | | | mm |
| inlet plug | Europe | | | | |
| weight | | | 96 | | g |

MECHANICAL DRAWING

units: mm

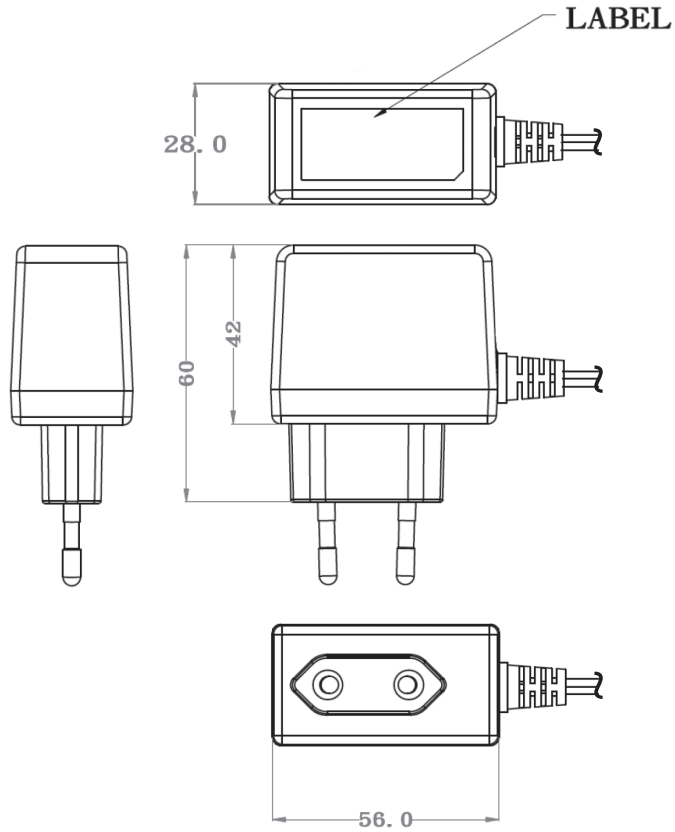

DC CORD

units: mm

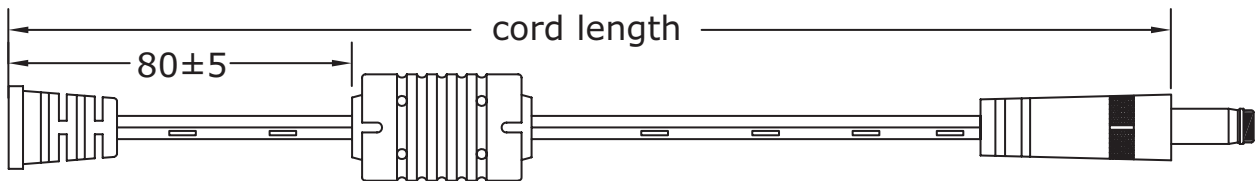
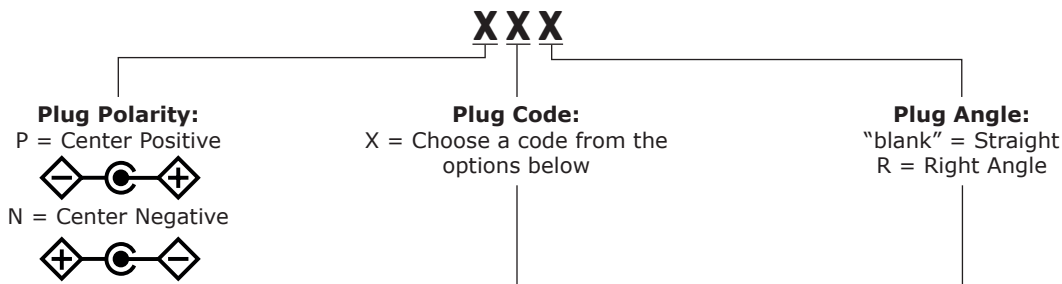

Table 1

| MODEL NO. | CABLE | CORD LENGTH |
|------------|--------|--------------|
| SWI6-3.3-E | UL2468 | 1,500 mm ±30 |
| SWI6-5-E | UL2468 | 1,500 mm ±30 |
| SWI6-5.9-E | UL2468 | 1,500 mm ±30 |
| SWI6-7.5-E | UL2468 | 1,500 mm ±30 |
| SWI6-9-E | UL2468 | 1,500 mm ±30 |
| SWI6-12-E | UL2468 | 1,500 mm ±30 |
| SWI6-15-E | UL2468 | 1,500 mm ±30 |

DC PLUG TYPE PART NUMBER KEY



| Plug Polarity | | Code | | Dimensions (mm) | | | Plug Angle | |
|---------------|-------------|--------|----------------------|------------------|------|-----|------------|-------|
| Center Pos. | Center Neg. | Option | Type | A | B | C | Straight | Right |
| • | • | 5 | Standard | 5.5 | 2.1 | 9.5 | • | • |
| • | • | 6 | Standard | 5.5 | 2.5 | 9.5 | • | • |
| • | • | 7 | Standard | 3.5 | 1.35 | 9.5 | • | • |
| • | • | 8 | Standard | 3.8 | 1.35 | 9.5 | • | • |
| • | • | 9 | Standard | 3.8 | 1.05 | 9.5 | • | • |
| • | • | 10 | Locking ² | 5.5 | 2.1 | 9.5 | • | N/A |
| • | • | 11 | Locking ² | 5.5 | 2.5 | 9.5 | • | N/A |
| • | • | 12 | EIAJ-1 | 2.35 | 0.7 | 9.5 | • | • |
| • | • | 13 | EIAJ-2 | 4.0 | 1.7 | 9.5 | • | • |
| • | • | 14 | EIAJ-3 | 4.75 | 1.7 | 9.5 | • | • |
| N/A | N/A | ST | Stripped & Tinned | | | N/A | N/A | |
| N/A | N/A | MUB | USB | Micro USB Type B | | | • | N/A |
| N/A | N/A | CUB | USB | USB Type C | | | • | N/A |

Note: 1. Contact CUI for additional plug options
 2. Maximum insertion depth is 10mm

Standard

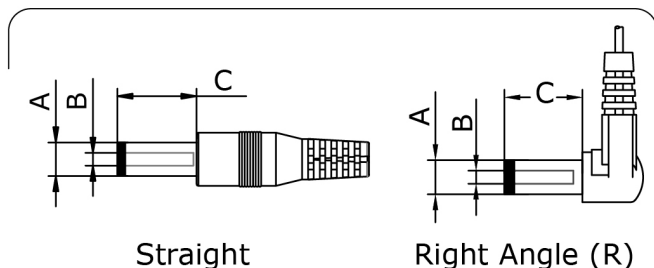

EIAJ

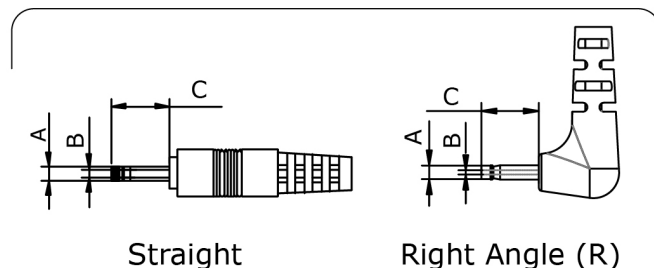

Locking

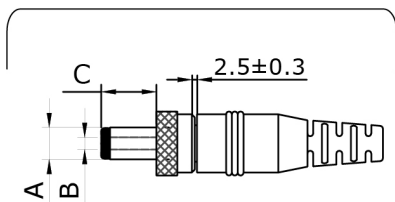

Stripped & Tinned

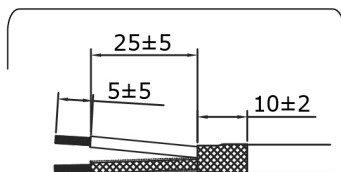

USB

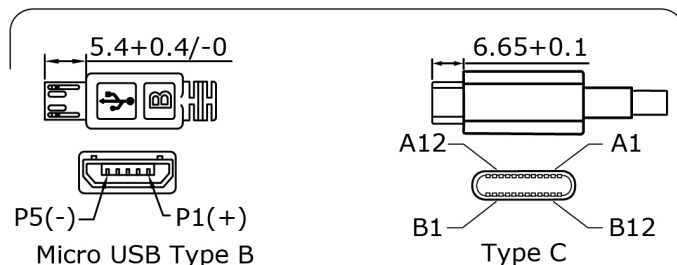

REVISION HISTORY

| rev. | description | date |
|------|---------------------------------------|------------|
| 1.0 | initial release | 08/07/2015 |
| 1.01 | added models | 08/12/2015 |
| 1.02 | updated drawing | 12/16/2015 |
| 1.03 | company logo updated | 09/21/2020 |
| 1.04 | updated dc plug options & model table | 12/04/2020 |
| 1.05 | safeties updated | 12/09/2020 |
| 1.06 | plug polarity symbols updated | 09/16/2021 |
| 1.07 | dc plugs updated | 06/15/2022 |

The revision history provided is for informational purposes only and is believed to be accurate.



CUI INC

a bel group

Headquarters
20050 SW 112th Ave.
Tualatin, OR 97062
800.275.4899

Fax 503.612.2383
cui.com
techsupport@cui.com

This device complies with part 15 of the FCC Rules. Operation is subject to the following two conditions:

- (1) This device may not cause harmful interference, and
- (2) this device must accept any interference received, including interference that may cause undesired operation.

CUI offers a one (1) year limited warranty. Complete warranty information is listed on our website.

CUI reserves the right to make changes to the product at any time without notice. Information provided by CUI is believed to be accurate and reliable. However, no responsibility is assumed by CUI for its use, nor for any infringements of patents or other rights of third parties which may result from its use.

CUI products are not authorized or warranted for use as critical components in equipment that requires an extremely high level of reliability. A critical component is any component of a life support device or system whose failure to perform can be reasonably expected to cause the failure of the life support device or system, or to affect its safety or effectiveness.