

Specifications

Electrical Ratings	50mA @ 50VDC	Dielectric Strength	250Vrms min
Electrical Life	100,000 cycles typical	Insulation Resistance	>100MΩ min
Contact Resistance	<50mΩ initial	Operating Temperature	-40°C to 85°C
Actuation Force	160 ± 50gF 250 ± 50gF	Storage Temperature	-40°C to 85°C
Actuation Travel	.30 ± .1mm		

Materials

Actuator	PA6T Nylon
Housing	PA6T Nylon
Cover	Stainless Steel
Contacts	Stainless Steel, Silver Plated
Terminals	Phosphor Bronze, Silver Plated

Ordering Information

1. Series	CS1207	F160
CS1207 J Lead CS1207M J Lead with mounting stems CS1207S Gull Wing CS1207SM Gull Wing with mounting stems		
2. Actuation Force		
F160 = 160gF		
F250 = 250gF		

Dimensions

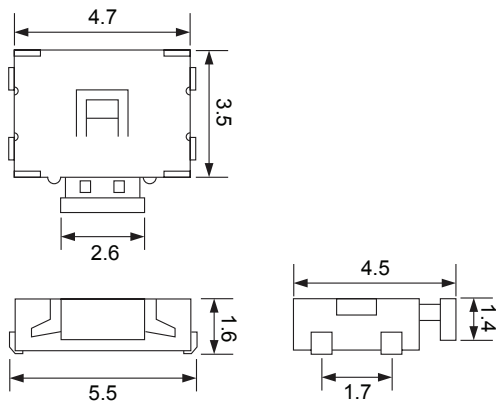

CS1207

Schematic & PC Layout

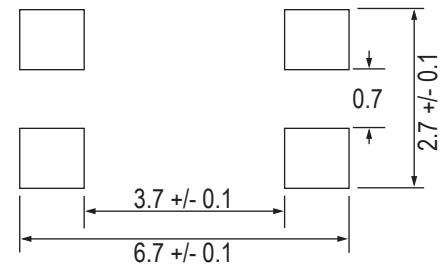
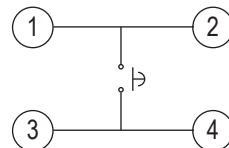

Dimensions

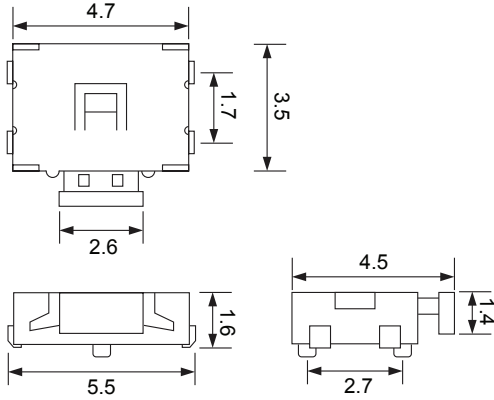

CS1207M

Schematic & PC Layout

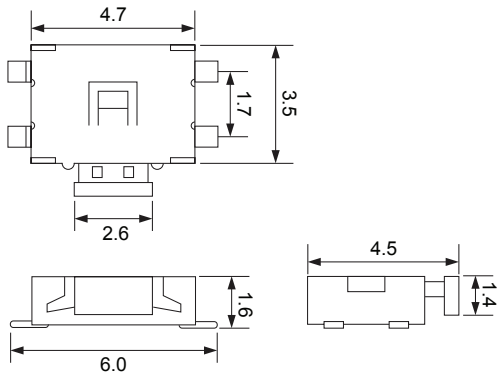
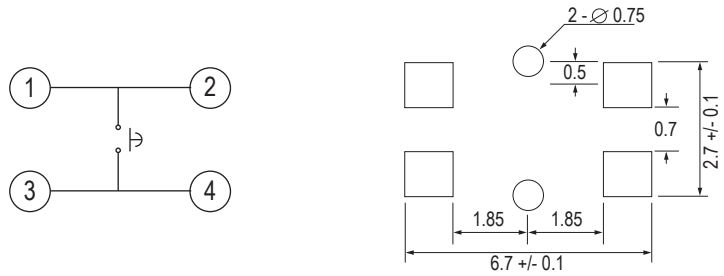

CS1207S

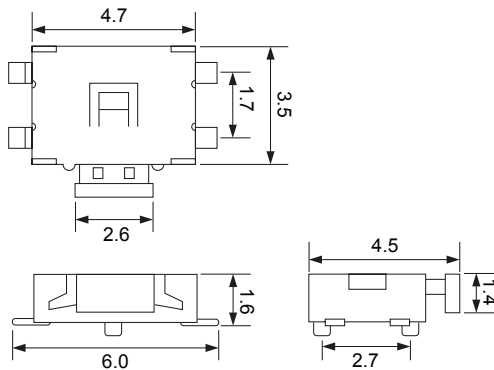
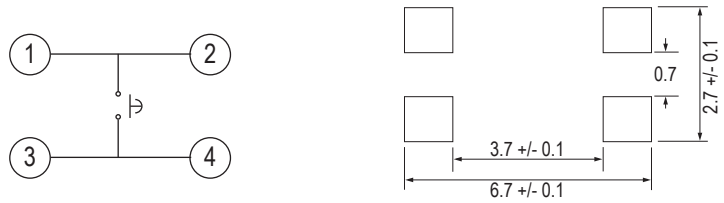

CS1207SM

