

CTL1206DGR2T DATASHEET

Chip Type LED, 1206, Dome Lens, Green



VENKEL LTD.

| Part Number | Size | Emitting Color | Emitting Material | Lens-Color | Luminous Intensity ($I_F=20\text{mA}$) mcd | Wavelength nm λ_P | Viewing Angle (2θ 1/2) |
|--------------|------|----------------|-------------------|-------------|---|---------------------------|-----------------------------------|
| CTL1206DGR2T | 1206 | Green | AllnGaP | Water Clear | 900.0 min 3600.0 typ | 520 | 20° |

| Electrical & Optical Specifications ($T_A=25^\circ\text{C}$) | GR1 (AlGaInP) | Unit |
|--|-----------------|--------------------|
| Forward Voltage (Min.) ($I_F=20\text{mA}$) | V_F | 3.3 V |
| Forward Voltage (Max.) ($I_F=20\text{mA}$) | V_F | 3.9 V |
| Reverse Current (Max.) ($V_R=5\text{V}$) | I_R | <100 μA |
| Peak Wavelength (Typ.) ($I_F=20\text{mA}$) | λ_P | 520 nm |
| Dominant Wavelength (Typ.) ($I_F=20\text{mA}$) | λ_D | 525 nm |
| Spectral Line Half Width (Typ.) ($I_F=20\text{mA}$) | $\Delta\lambda$ | 30 nm |

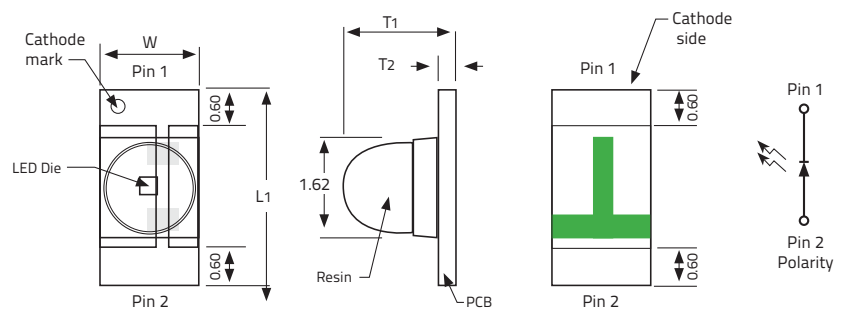

| Dimensions | | | | Units: Inches (mm) | | | |
|----------------------------|---------------------------|----------------------------|----------------------------|--------------------|-----|-------|-------|
| L_1 | W | T_1 | T_2 | L_1 | W | T_1 | T_2 |
| 0.1259±0.004 (3.20±0.1) | 0.0629±0.004 (1.6±0.1) | 0.0728±0.004 (1.85±0.1) | 0.0110±0.004 (0.28±0.1) | | | | |

| Absolute Maximum Ratings ($T_A=25^\circ\text{C}$) | GR1 (AlGaInP) | Unit |
|---|---------------|---------------|
| Reverse Voltage | V_R | 5 V |
| DC Forward Current | I_F | 20 mA |
| Peak Forward Current 1/10 Duty Cycle @ 10KHz | I_{FP} | 40 mA |
| Power Dissipation | P_D | 48 mW |
| Operating Temperature | T_A | -40 ~ +85 °C |
| Storage Temperature | T_{stg} | -40 ~ +100 °C |

Soldering Pad Layout

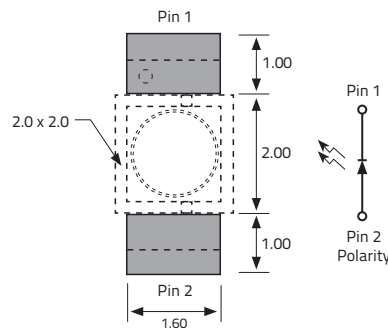

Tolerances are all ±0.1mm

CTL1206DGR2T DATASHEET

Chip Type LED, 1206, Dome Lens, Green



VENKEL LTD.

Graphs

Fig.1 Forward Current vs Forward Voltage

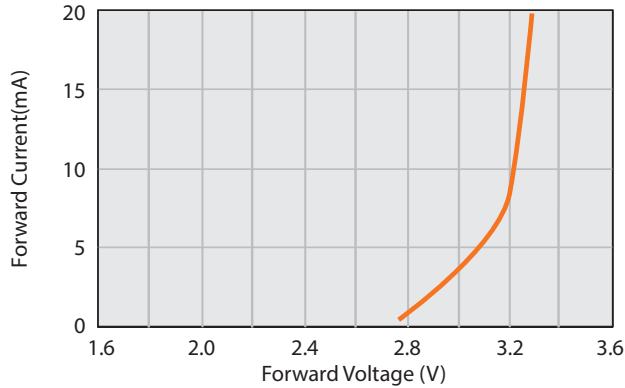

Fig.2 Relative Intensity vs Forward Current

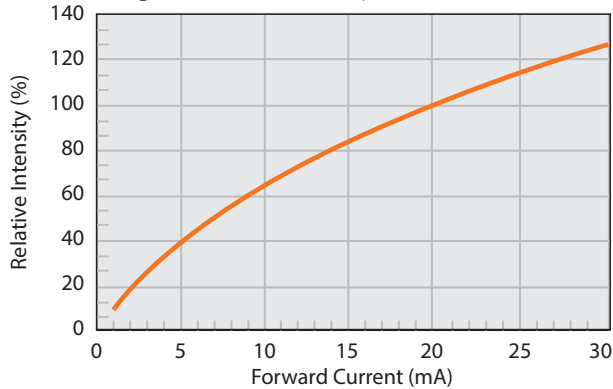

Fig.3 Current vs Temp

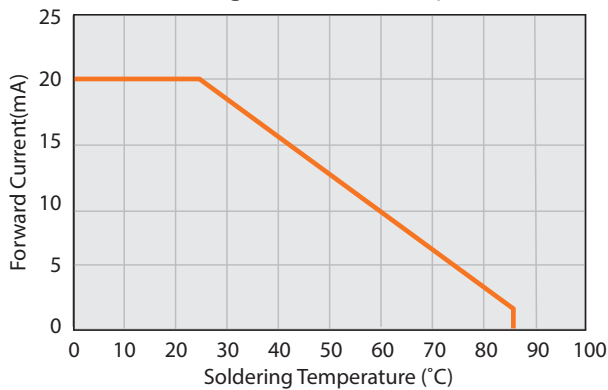

Fig.4 Relative Intensity vs Wavelength

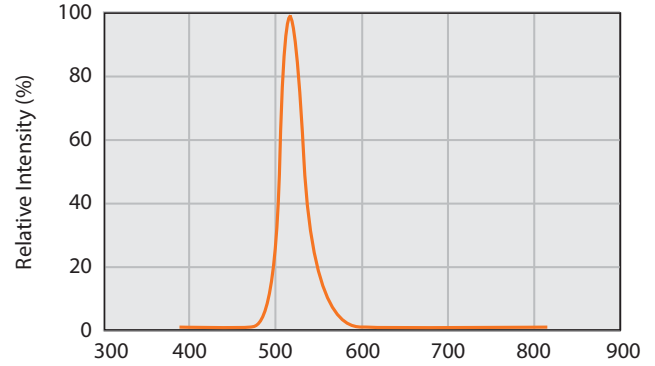
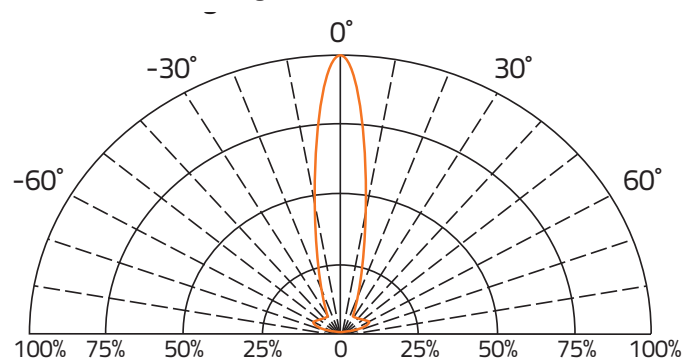

Fig.5 Direct Radiation



| Environmental information | |
|----------------------------------|-----------------------|
| RoHS Status | 6 of 6 Compliant |
| REACH Status | Compliant |
| Halogen Status | Halogen Free |
| Conflict Mineral Status | Conflict Mineral Free |
| Moisture Sensitivity Level (MSL) | 3 |

| Reflow profile | |
|--------------------------------|------------|
| Max Reflow Temperature | 260°C |
| Number of Reflow Cycles | 2 |
| Time at Max Reflow Temperature | 10 seconds |

CTL1206DGR2T DATASHEET

Chip Type LED, 1206, Dome Lens, Green



VENKEL LTD.

Label Example

Item: CTL1206DGR2T

Chip Type LED, 1206, Dome Lens, Red (Super Bright Red)

Qty: 2000

D/C: 1616

Lot: E1A1A22L12

BIN/HUE: AA/B

VF: 1.6V-2.4V

VENKEL LTD

YOUR SINGLE SOURCE FOR SURFACE MOUNT PASSIVES

Codes:

VF: Forward Voltage | BIN: Luminous Intensity | HUE: Dominant Wavelength

Luminous Intensity Classification (BIN Code)

| BIN Code | Iv(mcd) at 20mA | |
|----------|-----------------|--------|
| | Min. | Max. |
| Y | 900.0 | 1000.0 |
| Z | 1125.0 | 1440.0 |
| AA | 1440.0 | 1800.0 |
| AB | 1800.0 | 2250.0 |
| AC | 2250.0 | 2850.0 |
| AD | 2850.0 | 3600.0 |

Dominant Wavelength Classification (HUE Code)

| HUE Code | λ_D (nm) at 20mA | |
|----------|--------------------------|-------|
| | Min. | Max. |
| A | 515.0 | 520.0 |
| B | 520.0 | 525.0 |
| C | 525.0 | 530.0 |
| D | 530.0 | 535.0 |

CTL1206DGR2T DATASHEET

Chip Type LED, 1206, Dome Lens, Green



VENKEL LTD.

Reel Specifications

Units: mm

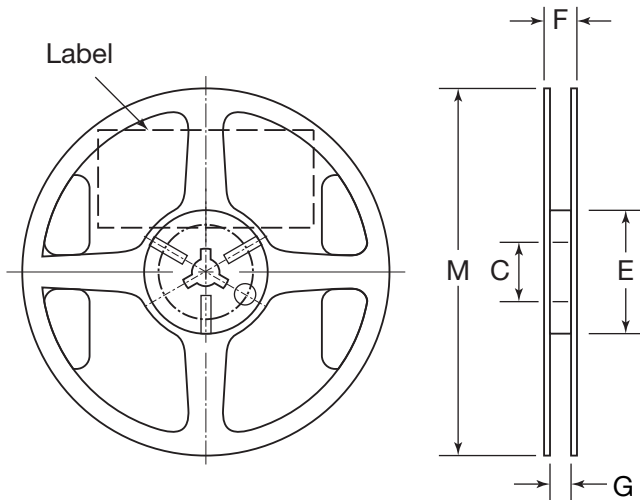

| M | C | F | E | G |
|----------|----------|----------|----------|---------|
| 178±1.50 | 13.0±1.0 | 12.0±1.0 | 60.0±1.0 | 9.0±1.0 |

Packaging Specifications

| | |
|---------------------|-------|
| Reel Size: | 7" |
| Quantity per Reel : | 2,000 |

Storage Specifications

1. Storage temperature and RH: 5°C~35°C, RH60%
2. Once the package is opened, the LEDs should be used within a week. Otherwise, they should be kept in a moisture proof bag with desiccant. We suggest that you use this product within one year from date code.
3. If opened for more than one week in an atmosphere of 5°C~35°C, RH60%. The parts should be heat treated at 60°C±5°C for 15 hours.

Tape Specifications

Units: mm

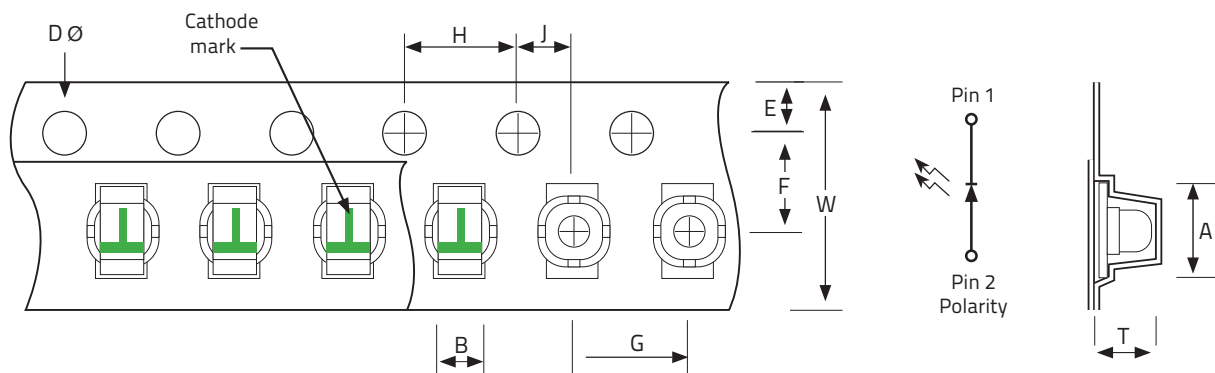

| | | | | |
|-----------|----------------|-----------|-----------|----------|
| T | W | A | B | F |
| 2.17±0.10 | 8.0+0.30/-0.10 | 3.37±0.10 | 1.78±0.10 | 3.5±0.05 |
| E | H | J | D | G |
| 1.75±0.1 | 4.0±0.1 | 2.0±0.05 | 1.5±0.1 | 4.0±0.1 |

CTL1206DGR2T DATASHEET

Chip Type LED, 1206, Dome Lens, Green



VENKEL LTD.

Environmental Test Criteria

| Classification | Test Item | Test Condition | Sample Size |
|--------------------|----------------------------|---|-------------|
| Endurance Test | Operating Life | 1. 25°C 2. 1000hrs | 40 |
| | High Temperature Storage | 1. 85°C±5°C 2. 1000hrs | 40 |
| | Temperature, Humidity Bias | 1. 40°C 2. 93% 3. 1000hrs | 40 |
| Environmental Test | Solderability | 1. 245°C / 3±1 sec 2. 260°C / 10±1 sec | 40 |