

THIS DRAWING CONTAINS INFORMATION PROPRIETARY TO RF INDUSTRIES.  
 ANY UNAUTHORIZED USE OF THIS DRAWING IS EXPRESSLY PROHIBITED  
 WITHOUT WRITTEN PERMISSION FROM RF INDUSTRIES.  
 ANY VIOLATION IS PUNISHABLE UNDER U.S. COPYRIGHT LAWS.

ALL DIMENSIONS ARE REFERENCE ONLY

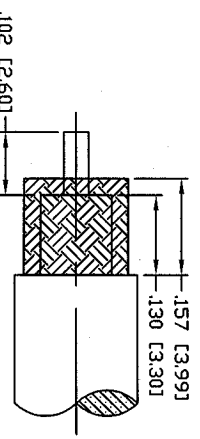
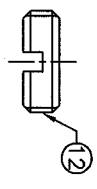
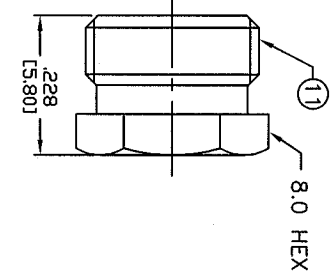
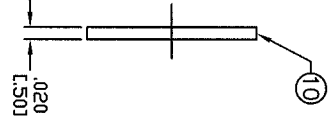
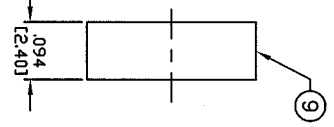
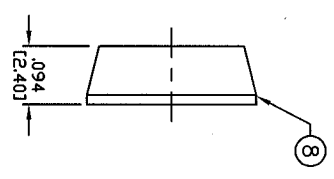
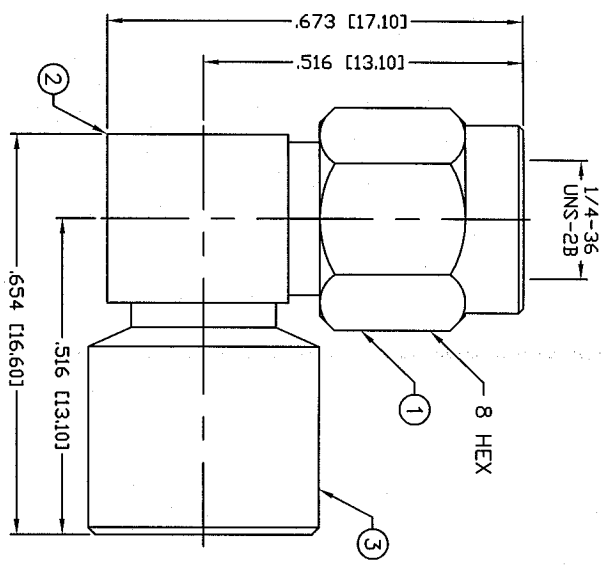

**SPECIFICATIONS:**  
 IMPEDANCE: 50 Ohms  
 FREQUENCY RANGE: 0-12.4 GHz  
 VSWR: 1.15 + .05 x  $\sqrt{F}=(\text{GHz})$   
 INSULATION RESISTANCE: 5000 MegOhms  
 TEMPERATURE RANGE: -65°C TO +165°C  
 FOR RG-58, 58A, 58C, 141, 141A, BELDEN 8240,  
 8259, 8262, 9201, 9203, 9310, 9311 & COMM/SCOPE 0268

#	DESCRIPTION	QTY	MATERIAL	FINISH (IN)	APPROVALS	DATE
1	SHELL	1	BRASS	NICKEL, 100μ	008974	
2	BODY	1	BRASS	NICKEL, 100μ		
3	PRESS BODY	1	BRASS	NICKEL, 100μ		
4	INSULATOR	1	PIFE	---		
5	PIN	1	BRASS	GOLD, 50μ		
6	RETAINING RING	1	Be, Cu	---		
7	GASKET	1	SILICONE	RED		
8	CLAMP	1	BRASS	NICKEL, 100μ		
9	GASKET	1	SILICONE	RED		
10	WASHER	1	BRASS	NICKEL, 100μ		
11	CLAMP NUT	1	BRASS	NICKEL, 100μ		
12	SCREW CAP	1	BRASS	NICKEL, 100μ		
13						
14						

UNLESS OTHERWISE SPECIFIED:  
 1. REMOVE ALL BURRS  
 2. BREAK ALL CORNERS & EDGES .005 R. MAX.  
 3. CHAMFER 1ST & LAST THREADS 45°  
 4. SURFACE ROUGHNESS 63 FINISH MIL-STD-10  
 5. DIAMETERS ON COMMON CENTERS TO BE CONCENTRIC WITHIN .002 T.I.R.  
 6. ALL DIMENSIONS ARE AFTER PLATING.

DIMENSIONS ARE IN INCHES AND [MILLIMETERS]  
 UNLESS OTHERWISE NOTED TOLERANCES ARE:  
 DECIMALS .XXX±.003 [.08]  
 DIAMETER .XXX±.001 [.03]  
 .XXX±.005 [.13]

PART NO. <b>RSA-3110-C</b>		DWN	DATE	APPROVED
REV	DESCRIPTION			
A	ENGINEERING RELEASE	KMM	4/15/94	F. VIERA
B	CHANGE DWG. NUMBER FROM 8341A	CZS	9/19/01	JDMc

**RF Connectors**  
 DIVISION OF RF INDUSTRIES, LTD.  
 7610 MIRAMAR RD  
 SAN DIEGO, CA 92126  
 (858) 549-6340  
 (858) 549-6345 FAX

**SMA PLUG**

R/A CLAMP

SIZE	CABLE GROUP	DWG NO.	REV
A	C	RSA-3110-C	B
SCALE:	NTS	CAD FILE	OUTLINE
SHEET	1	OF	1