

TABLE OF CONTENTS	
SHEET NO.	SHEET DESCRIPTION
1	NOTES
2	CONFIGURATIONS
3	BOM AND OUTER DIMENSIONS
4	INTERFACE

NOTES: VALID UNLESS OTHERWISE SPECIFIED

1. GENERAL:

a. APPLICATION SPECIFICATION SEE: 1480327001

- CONTAINS: PRODUCT INTRODUCTION, PRODUCT SUMMARY, CONNECTOR ASSEMBLY, PACKAGING INFORMATION, CONNECTOR MATING, SERVICE INSTRUCTIONS, ELECTRICAL CONTINUITY CHECKING, CRIMPING, AND TROUBLESHOOTING.
- DESIGNED TO MATE WITH DEVICE CONNECTOR AS SPECIFIED IN THE MATING INTERFACE/CONNECTOR DRAWINGS CHART.
- ASSEMBLY SHIPPED WITH PLR IN PRE-LOCK POSITION
- FOR 1.5MM RECEPTACLE TERMINAL TO BE USED WITH THIS ASSEMBLY SEE MOLEX DRAWING RSD-33012-002 AND YAZAKI DRAWING 7116-4100-02:R.
- ASSEMBLY CONFORM TO GMW3191 2012 WITH THE FOLLOWING EXCEPTION: CONNECTOR LOCK MECHANICAL OVERSTRESS VERTICAL DIRECTION:80N MIN.

b. PRODUCT SPECIFICATION SEE:1480327002

- CONTAINS:SCOPE, PRODUCT DESCRIPTION, INTEGRAL COMPONENTS AND ACCESSORIES, APPLICABLE DOCUMENTS AND SPECIFICATIONS, RATINGS, PERFORMANCE, PACKAGING, GAUGE AND FIXTURES, AND OTHER INFORMATION.

c. PACKAGING SPECIFICATION PER MOLEX DRAWING: PK148032-001

d. PARTS MUST BE IN COMPLIANCE TO MOLEX CHEMICAL SUBSTANCES FOR PRODUCTS AND PACKAGING SPECIFICATION: QEHS-699000-301

e. DATA MUST BE SUBMITTED UNDER THE MOLEX PART NUMBER TO IMDS (COMPANY ID#13255)

2. DESIGN - MATERIALS:

a. FOR BILL OF MATERIALS SEE BOM TABLE

3. DESIGN - GEOMETRY:

- a. THE 3-D CAD DATA IS BASIC (WITHOUT TOLERANCE) AND MASTER FOR THIS PART WITH THE EXCEPTION OF UNDERLINED DIMENSIONS. DIMENSIONAL INFORMATION NOT SHOWN ON THIS DRAWING IS DEFINED BY THE DATA FILE AT ITS LATEST REVISION.
- b. GEOMETRIC DIMENSIONS AND TOLERANCES PER ASME Y14.5M-2009
- c. EDGES AND UNDIMENSIONED DETAILS PER ISO13715
- d. CORNERS SHOWN AS SHARP TO BE R 0.2 MAX.
- e. LETTERING SHALL BE 0.15 MAX RAISED IN 0.25 MAX RECESS PAD. THIS INCLUDES RECYCLING CODE, CAVITY ID, VENDOR IDENTIFICATION, AND CUSTOMER MATERIAL NUMBER.
- f. VISUAL DEFECTS SHALL MEET COSMETIC STANDARD PS-45499-002 (Class B).
- g. LASER MARKING:
 1. PART NUMBER
 2. DAY OF THE YEAR
 3. SHIFT
 4. YEAR

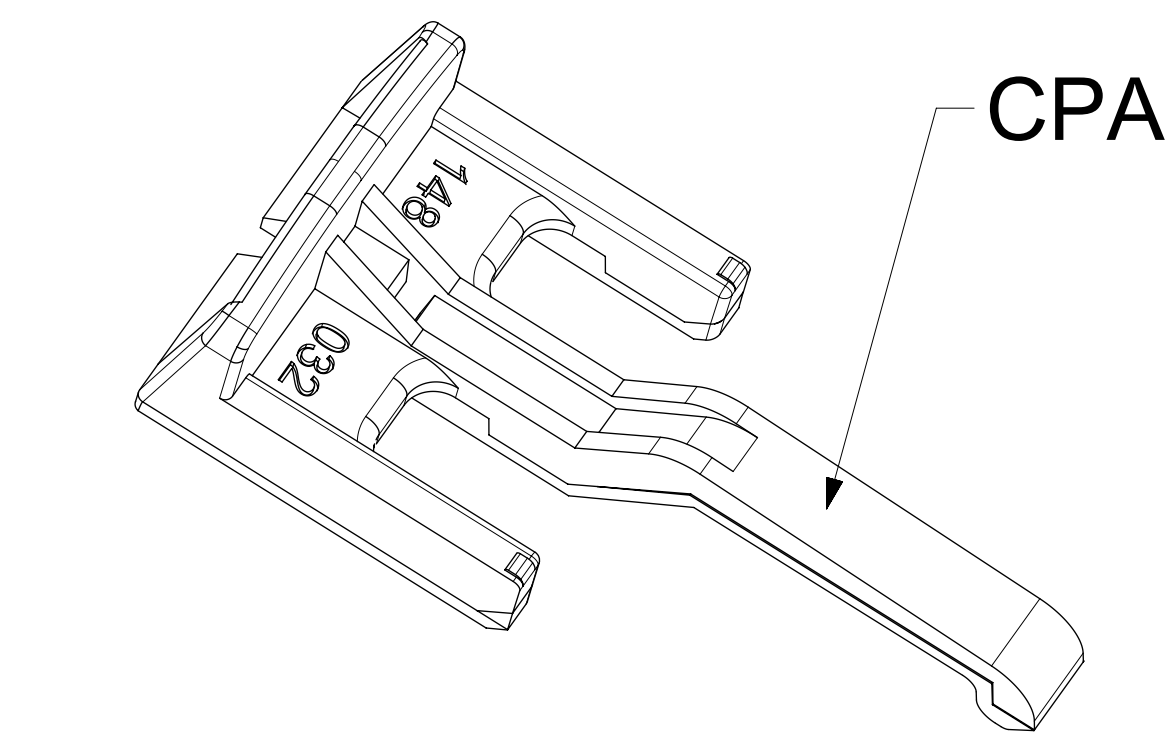

CPA

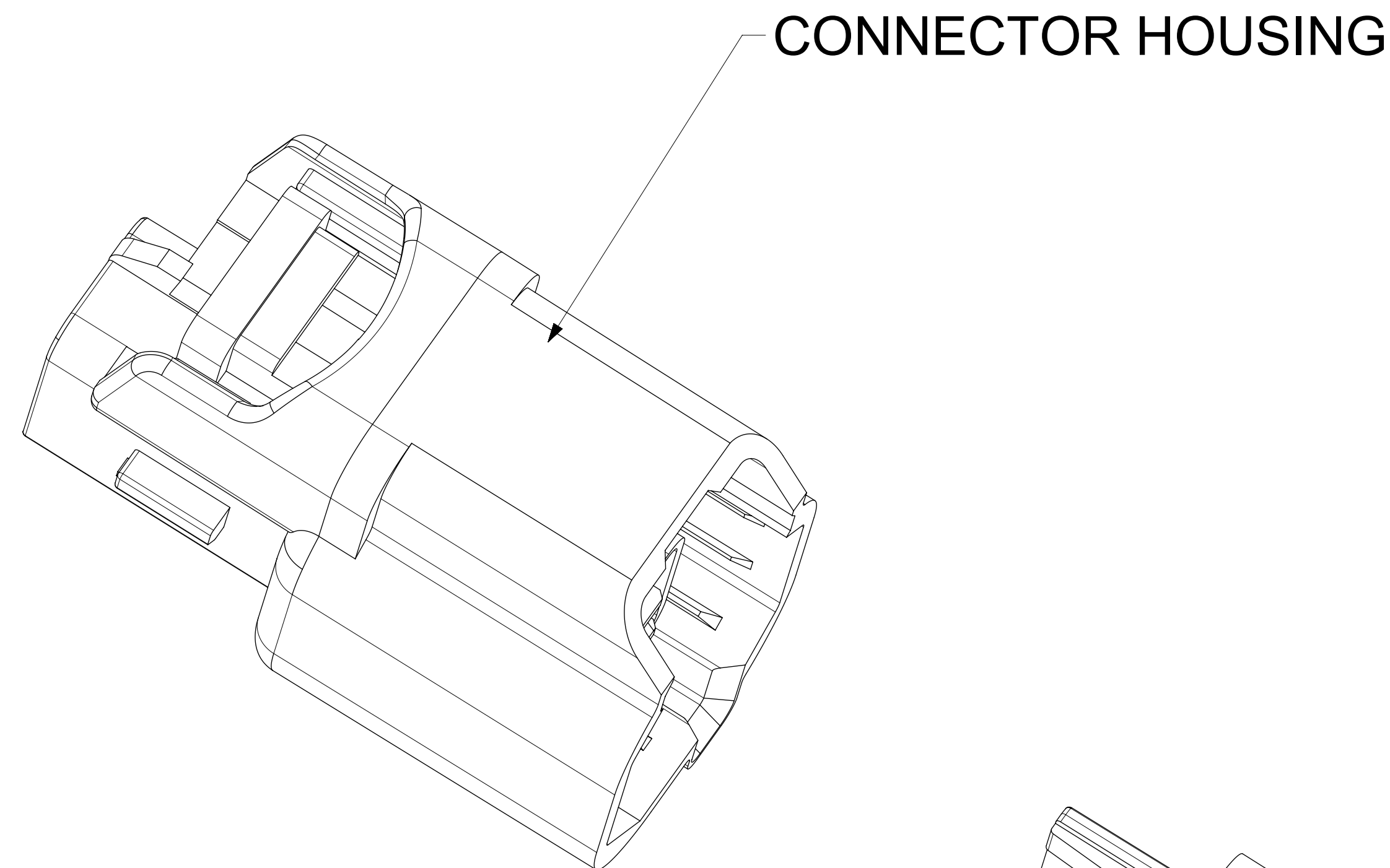

CONNECTOR HOUSING

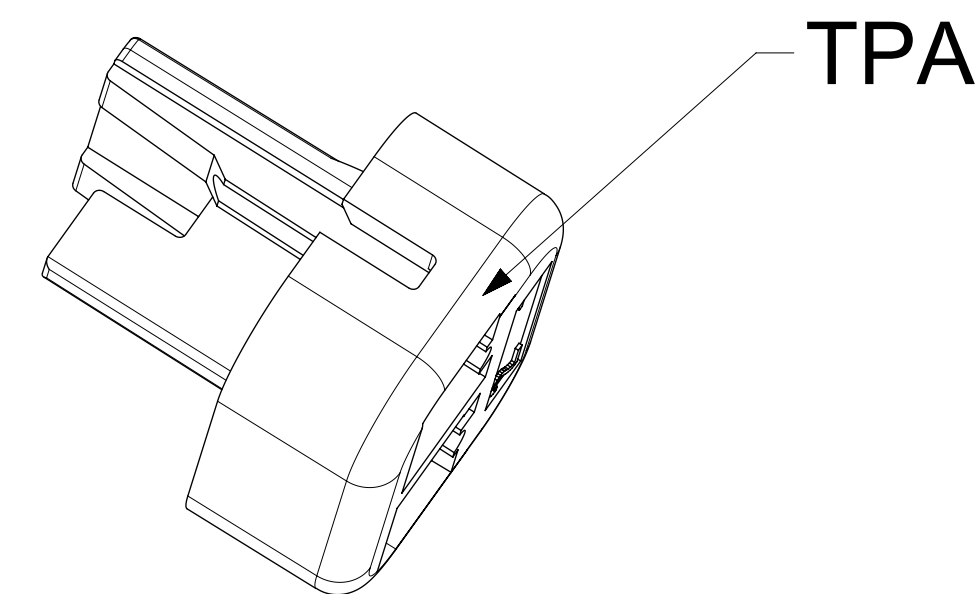

TPA

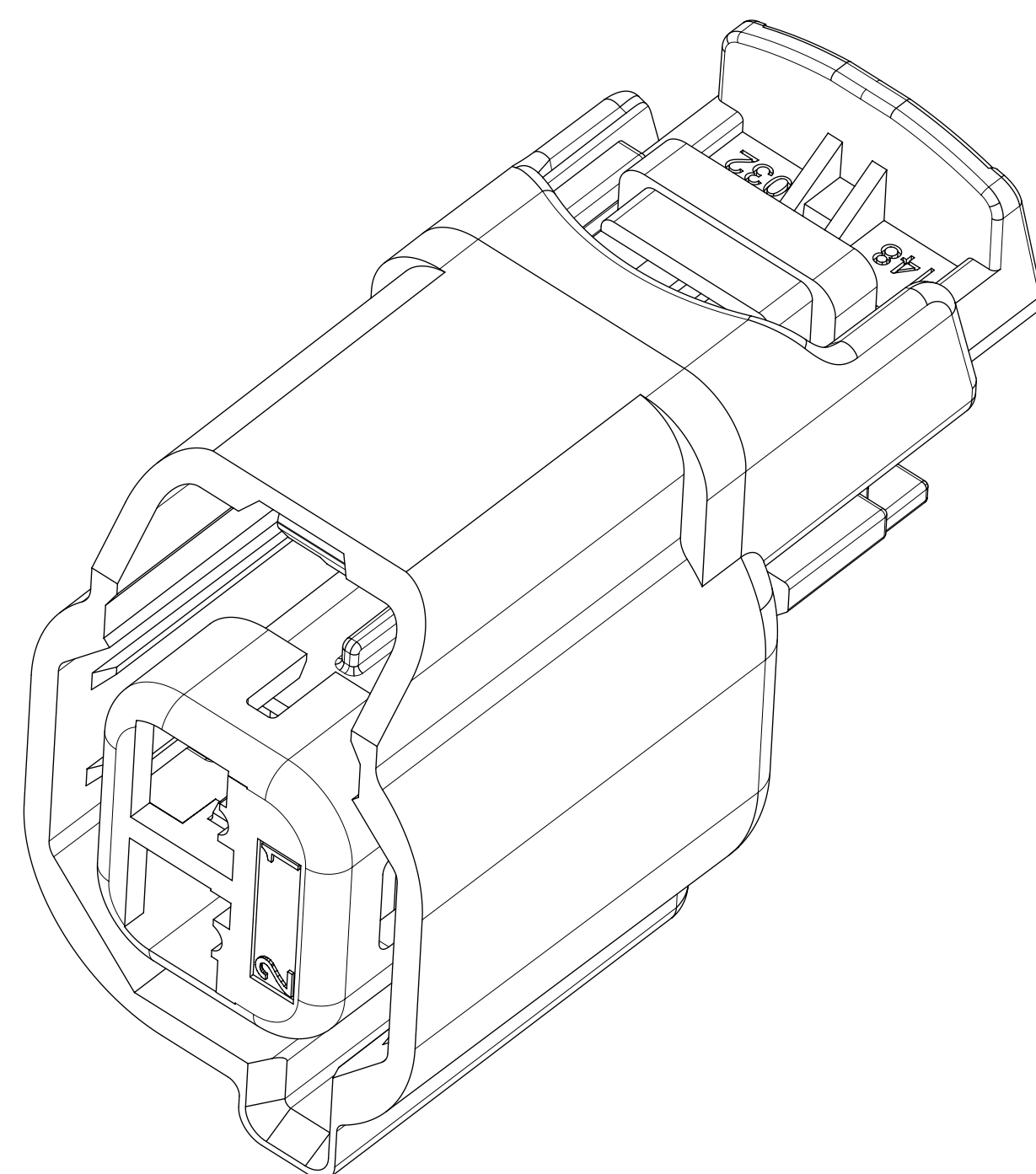

THIS DRAWING CONTAINS INFORMATION THAT IS PROPRIETARY TO MOLEX ELECTRONIC TECHNOLOGIES, LLC AND SHOULD NOT BE USED WITHOUT WRITTEN PERMISSION												
QUALITY SYMBOLS FA = 0 FE = 0 FE = 0 ▼ = 0 C = 0 ☒ = 0 ■ = 0 ∇ = 0	EC NO: 110742 DRWN: XBTANG CHKD: JDENG02 APPR: JDENG02	2016/11/23 2016/12/21	GENERAL TOLERANCES (UNLESS SPECIFIED)		DIMENSION UNITS	SCALE						
			ANGULAR TOL ± 3.0 °		MM	5:1						
			4 PLACES ±	XBTANG	DATE	2016/08/22						
			3 PLACES ±	XBTANG	DATE	2016/09/20						
2 PLACES ± 0.1		JDENG02	DATE	2016/09/26	DRAWING SIZE		THIRD ANGLE PROJECTION	SERIES	MATERIAL NUMBER	CUSTOMER		
1 PLACE ± 0.3		A1	THIRD ANGLE PROJECTION	148032	SEE BOM	GENERAL MARKET		DOCUMENT NUMBER		DOC TYPE	DOC PART	SHEET NUMBER
0 PLACES ±		DRAFT WHERE APPLICABLE MUST REMAIN WITHIN DIMENSIONS		A1	THIRD ANGLE PROJECTION		1480324100	CD	000	1 OF 4		

CONFIGURATIONS

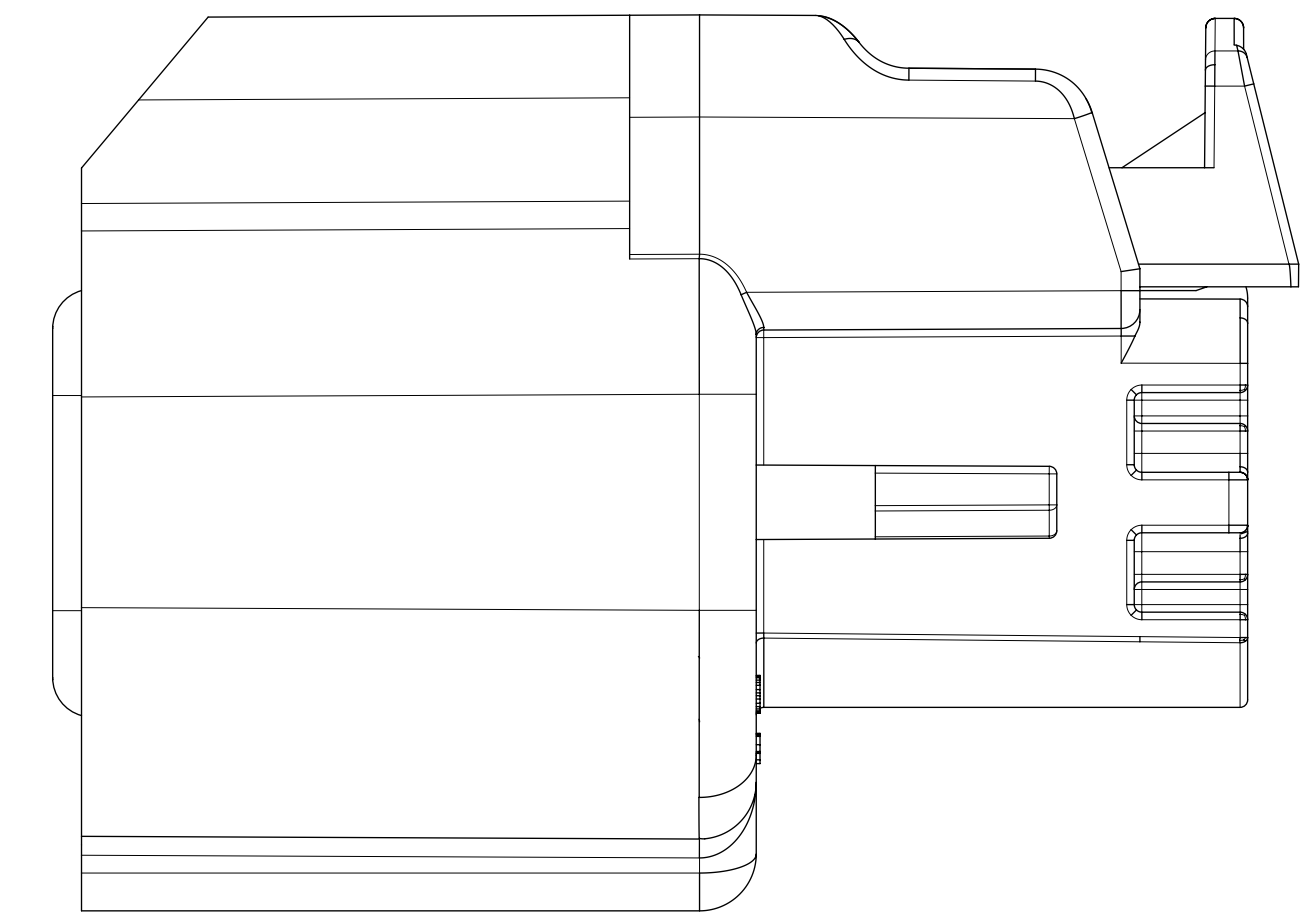
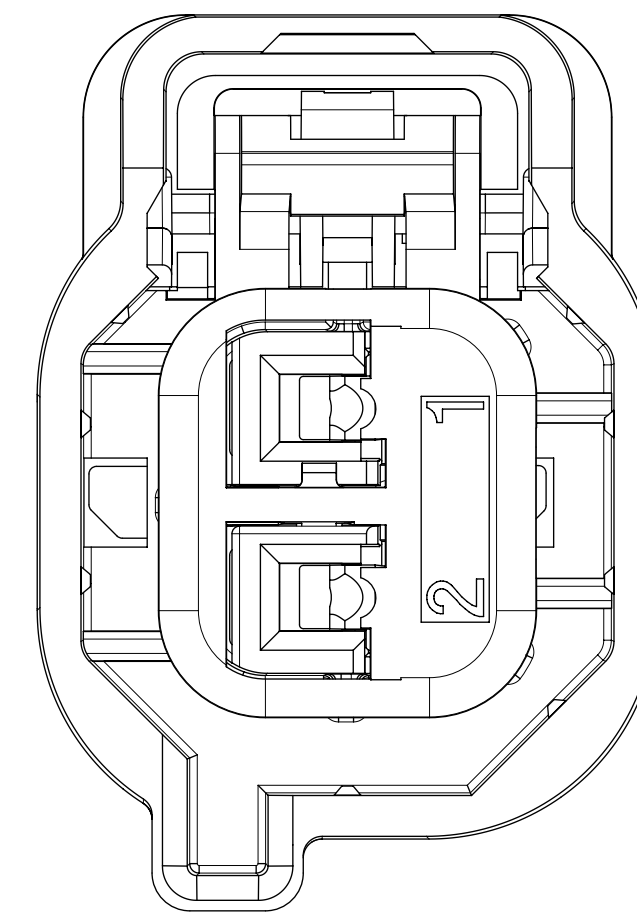
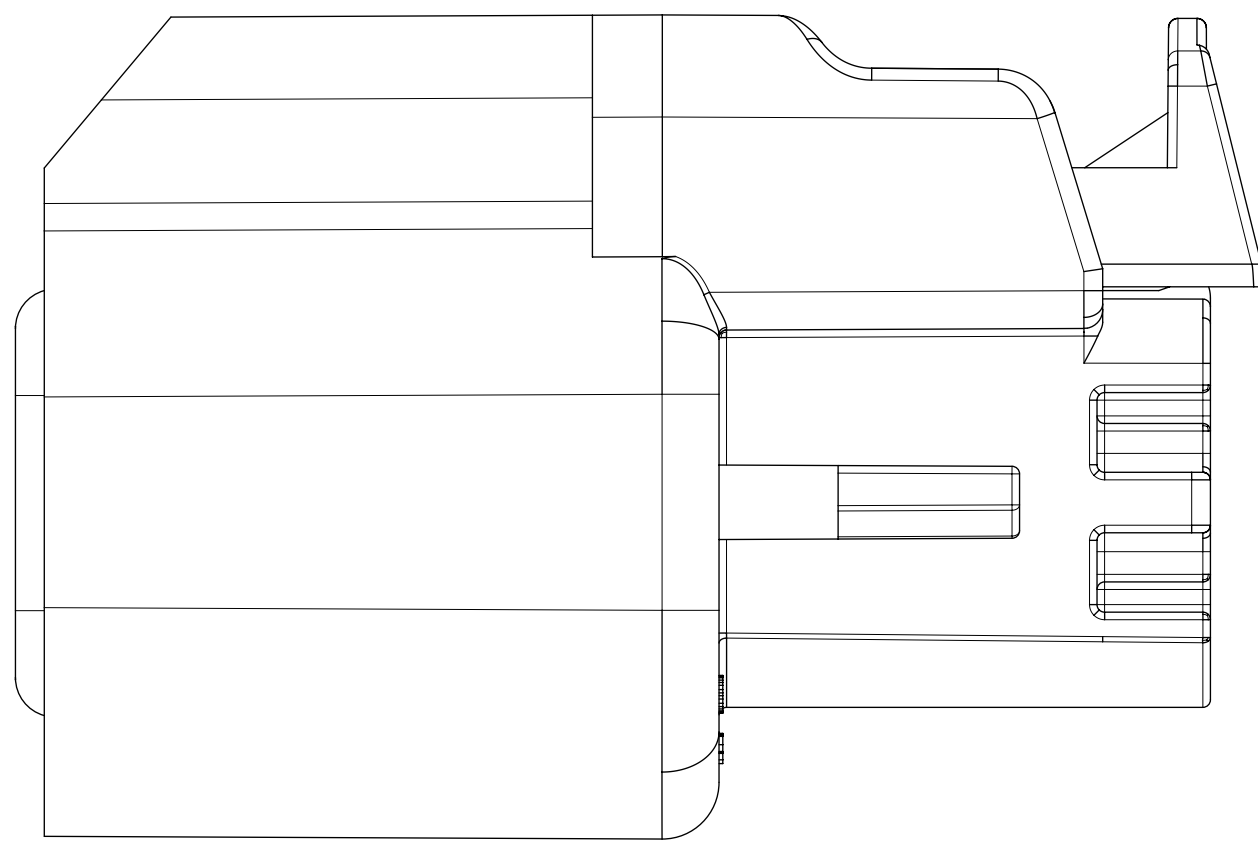
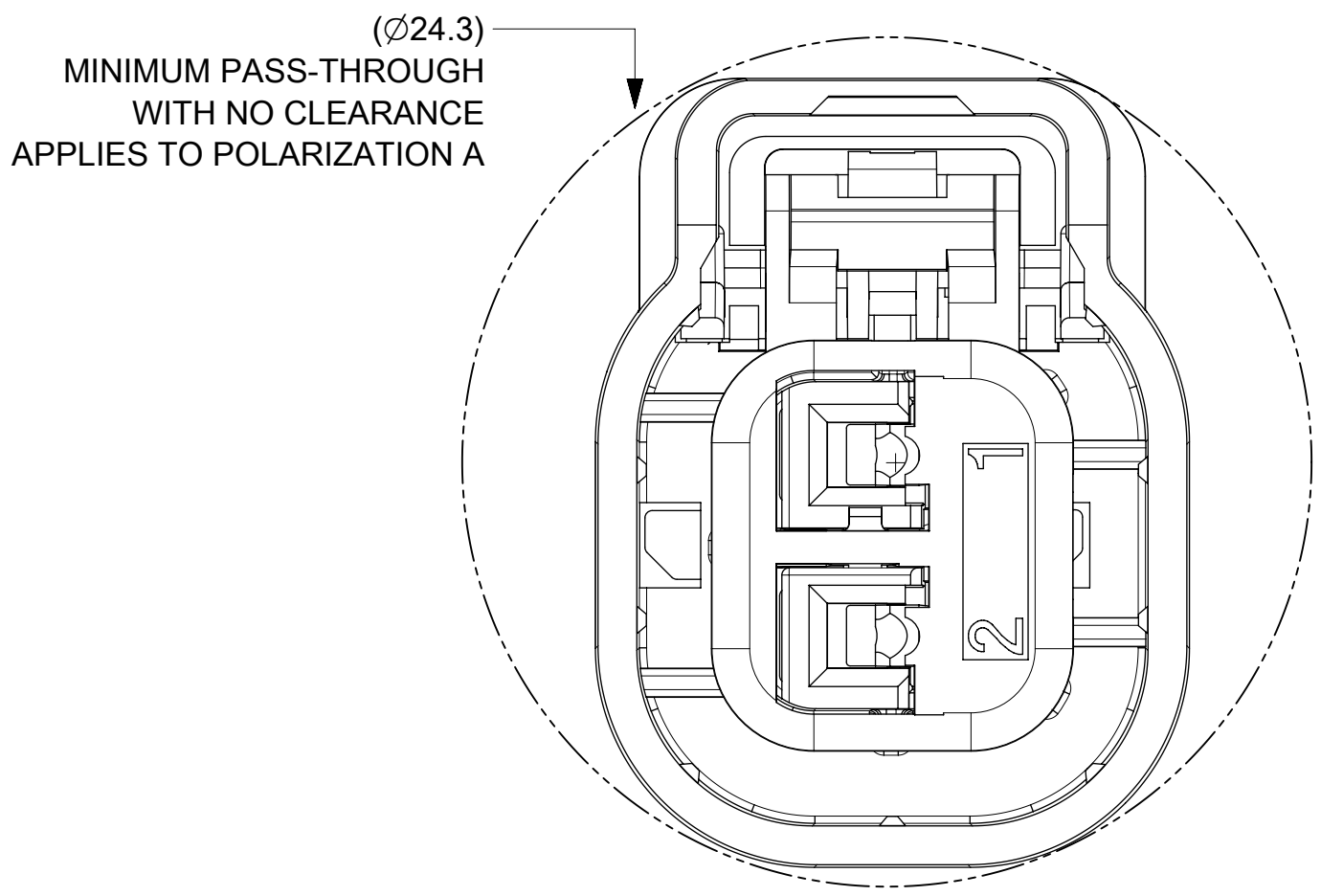

"A" POLARIZATION

"D" POLARIZATION

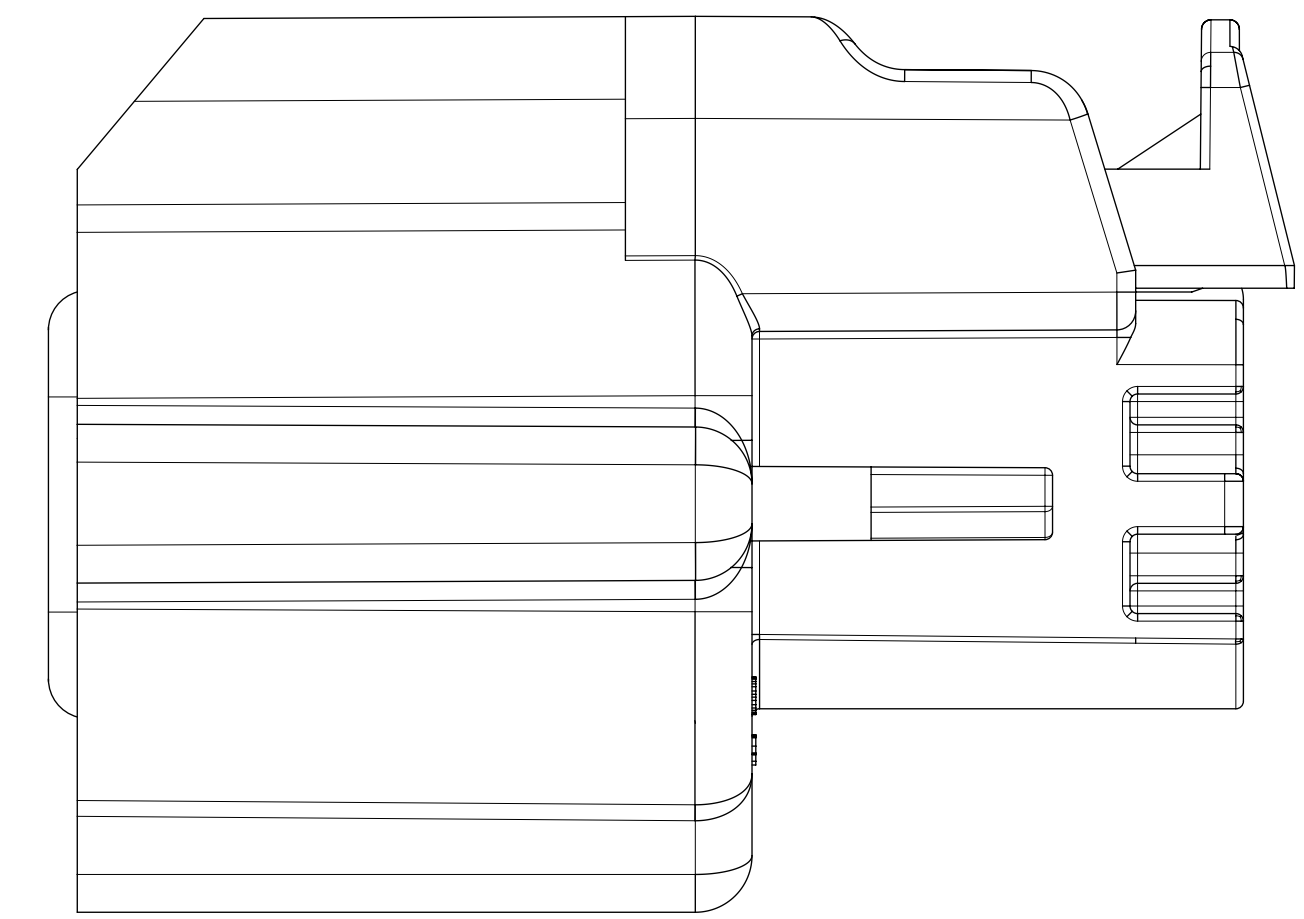
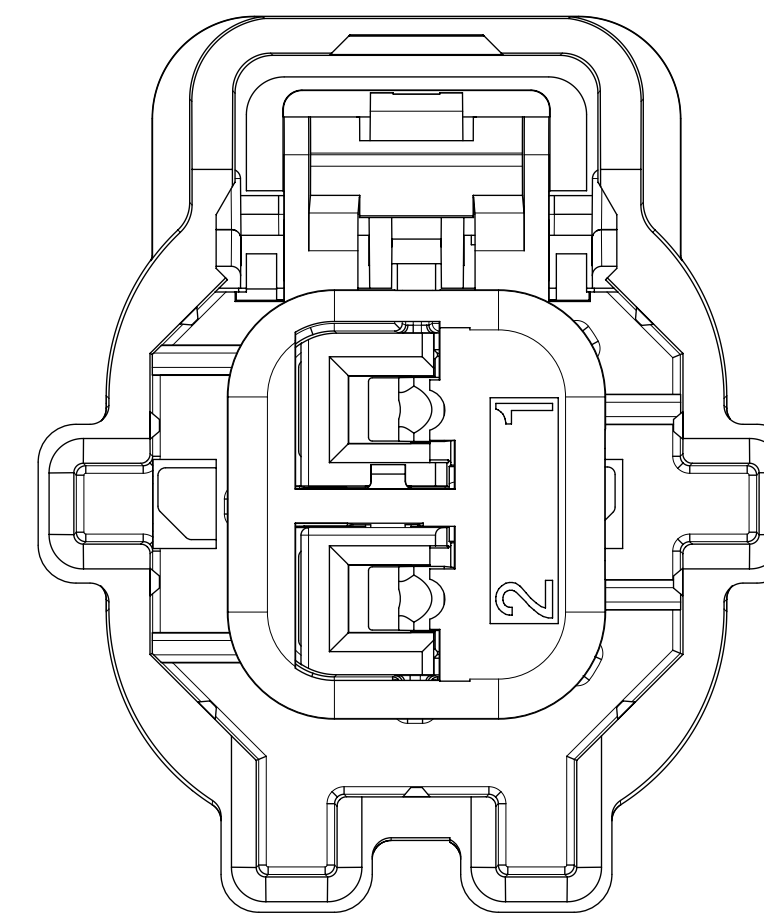
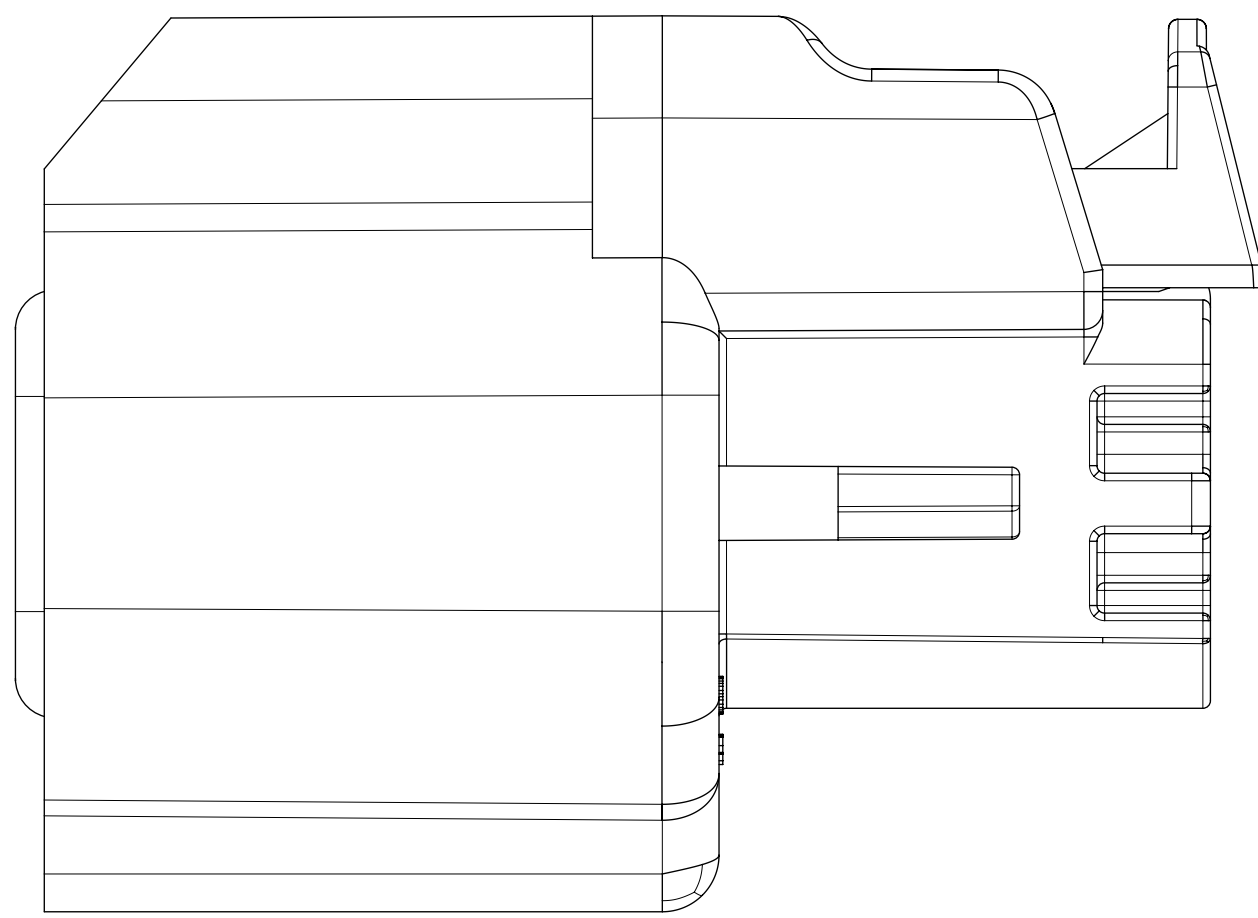
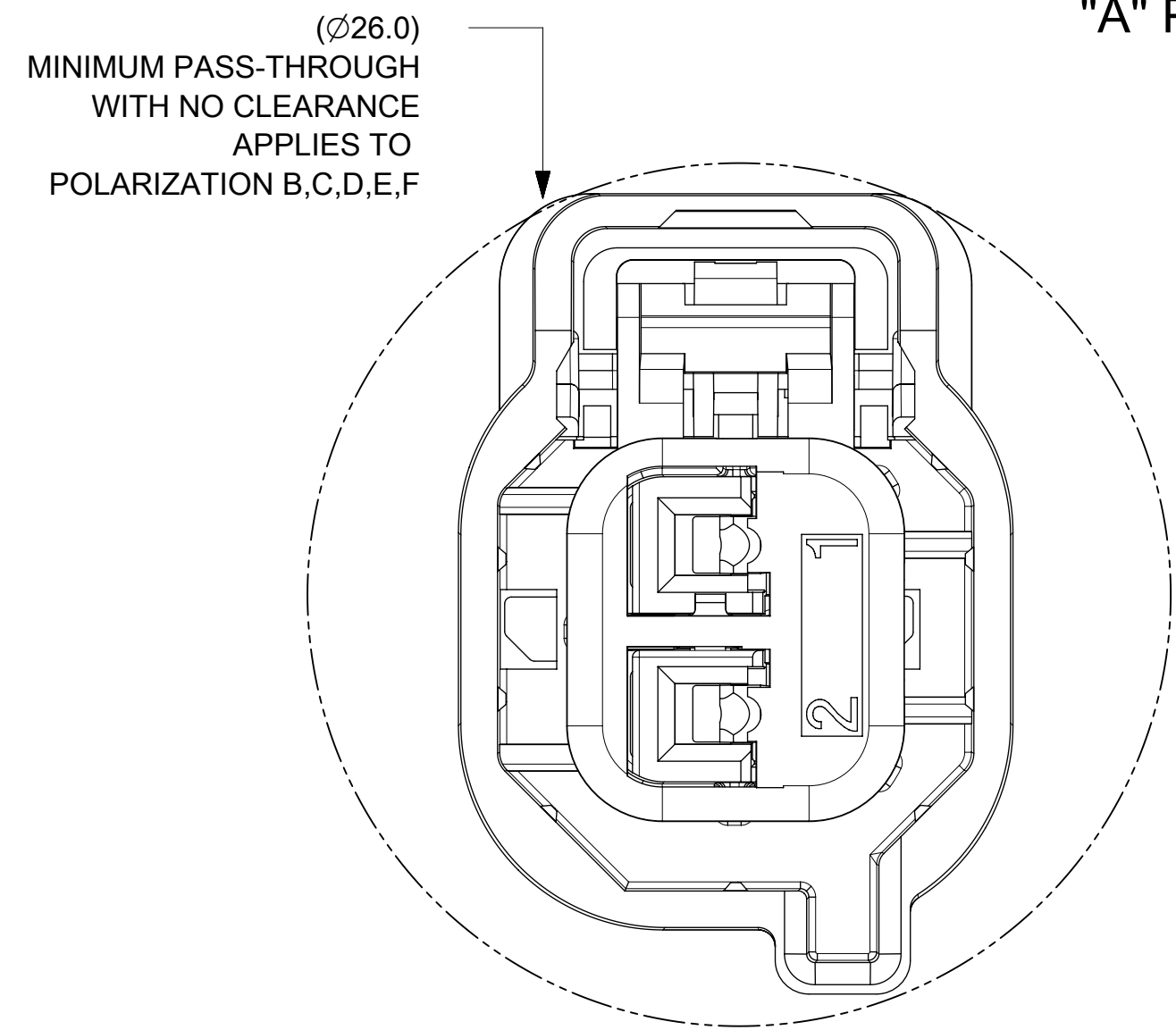

"B" POLARIZATION

"E" POLARIZATION

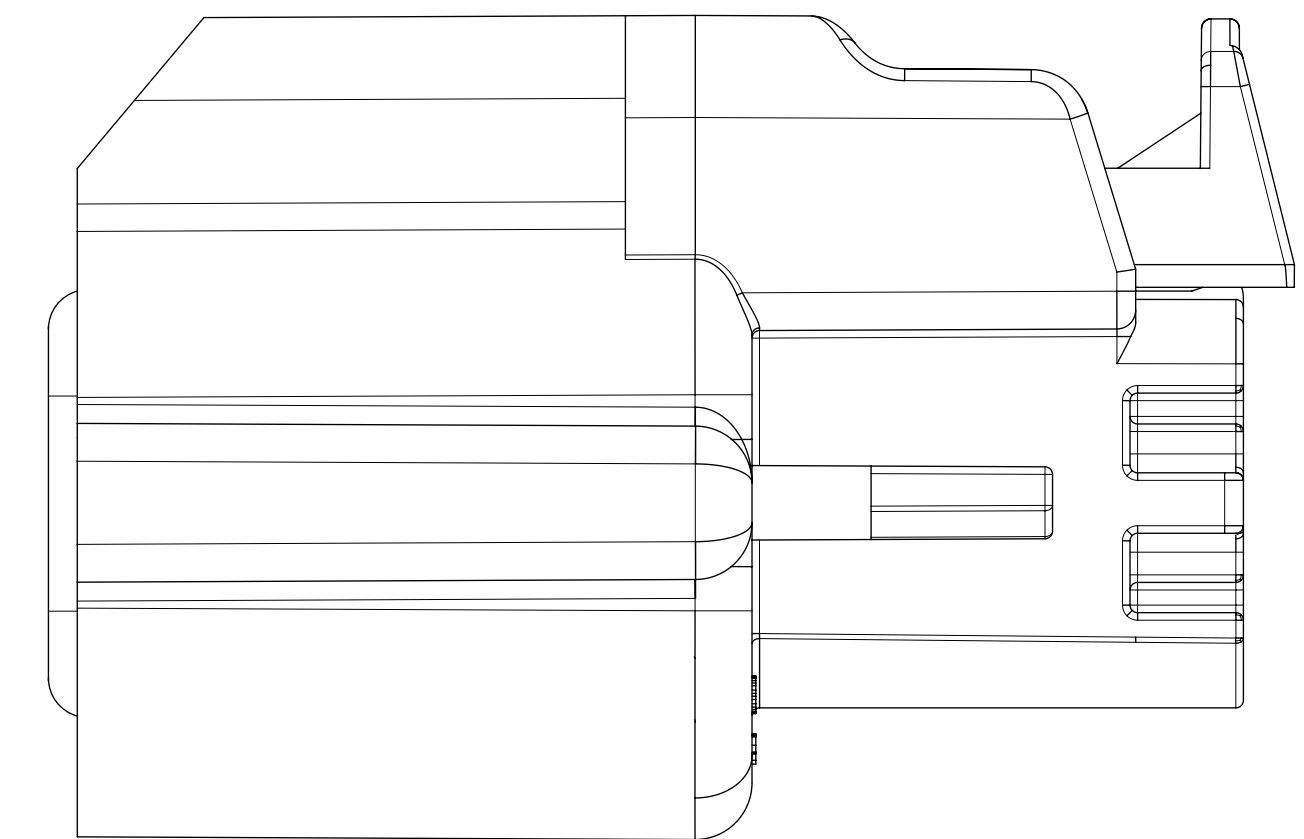
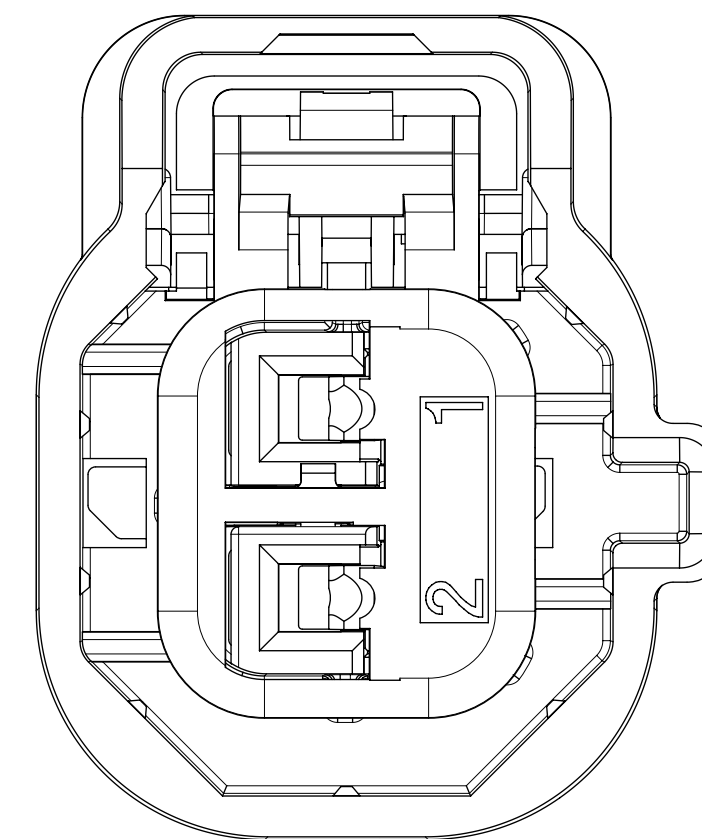
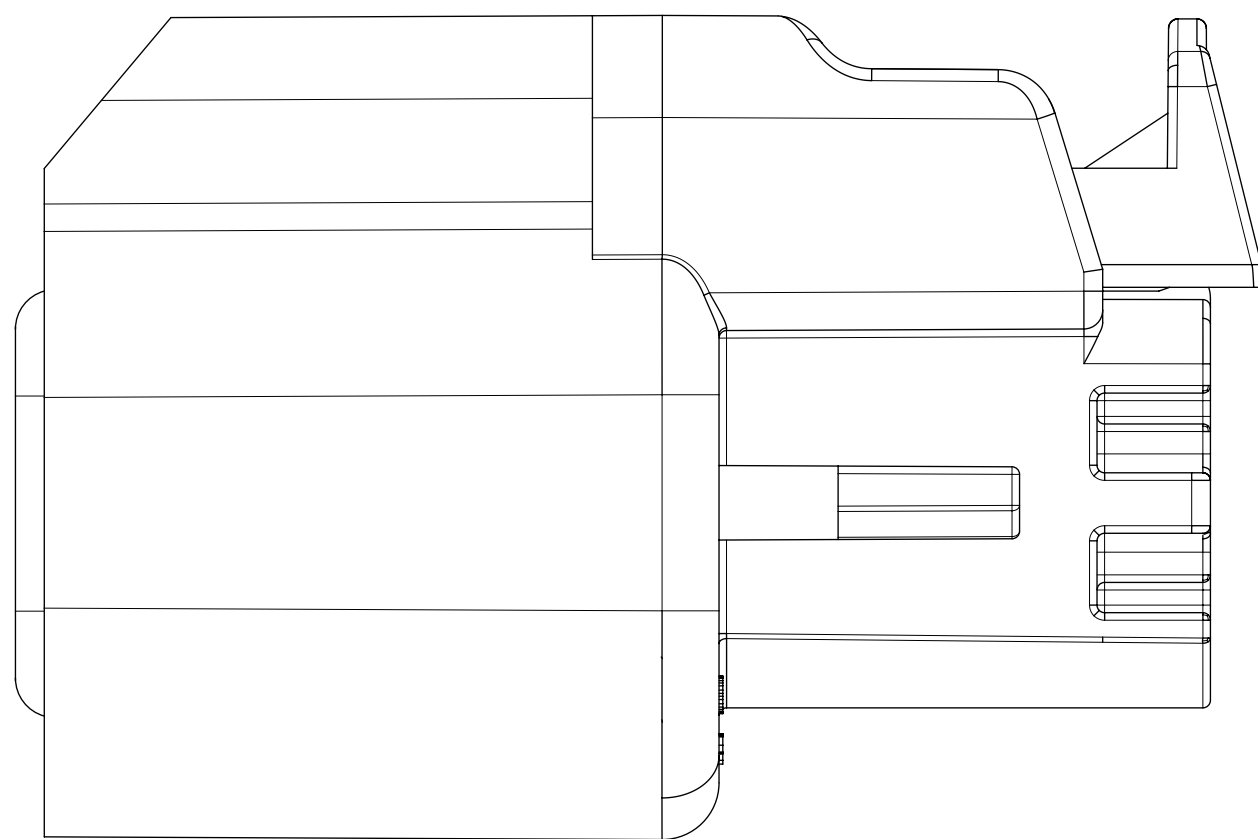
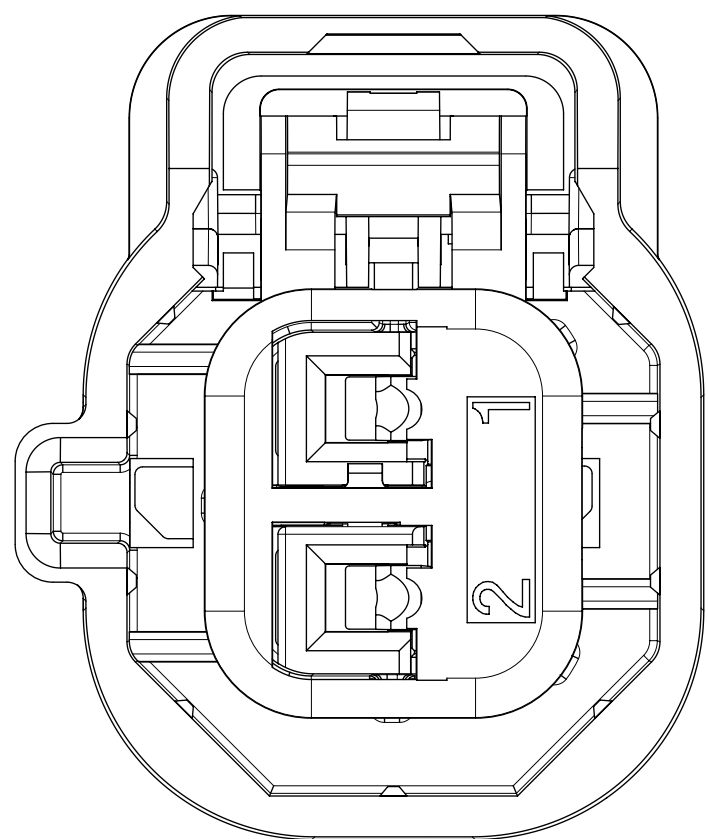

"C" POLARIZATION

"F" POLARIZATION

THIS DRAWING CONTAINS INFORMATION THAT IS PROPRIETARY TO MOLEX ELECTRONIC TECHNOLOGIES, LLC AND SHOULD NOT BE USED WITHOUT WRITTEN PERMISSION											
QUALITY SYMBOLS □ = 0 ▽ = 0 ▽ = 0 ▽ = 0 ▽ = 0 ▽ = 0 ▽ = 0 ▽ = 0 ▽ = 0 ▽ = 0 ▽ = 0 ▽ = 0 ▽ = 0	EC NO: 110742	DRWN: XBTANG	CHKD: JDENG02	APPR: JDENG02	GENERAL TOLERANCES (UNLESS SPECIFIED)	DIMENSION UNITS	SCALE				
	2016/11/23	2016/11/23	2016/11/23	2016/11/23	MM	5:1					
	2016/11/23	2016/11/23	2016/11/23	2016/11/23	DRWN BY	DATE					
	4 PLACES ±	ANGULAR TOL ± 3.0 °	XBTANG	2016/08/22	GM2W UNSEAL SPEAKER ASSEMBLY SALES DRAWING						
	3 PLACES ±	2 PLACES ± 0.1	CHK'D BY	DATE							
	2 PLACES ± 0.1	1 PLACE ± 0.3	XBTANG	2016/09/20							
1 PLACE ± 0.3	0 PLACES ±	APPR BY	DATE	CUSTOMER DRAWING							
0 PLACES ±	DRAFT WHERE APPLICABLE MUST REMAIN WITHIN DIMENSIONS	JDENG02	2016/09/26								
DRAWING SIZE	THIRD ANGLE PROJECTION										
A1				SERIES	MATERIAL NUMBER	CUSTOMER		148032 SEE BOM GENERAL MARKET			
				DOCUMENT NUMBER	DOC TYPE	DOC PART	SHEET NUMBER				
				1480324100	CD	000	2 OF 4				

BOM AND OUTER DIMENSIONS

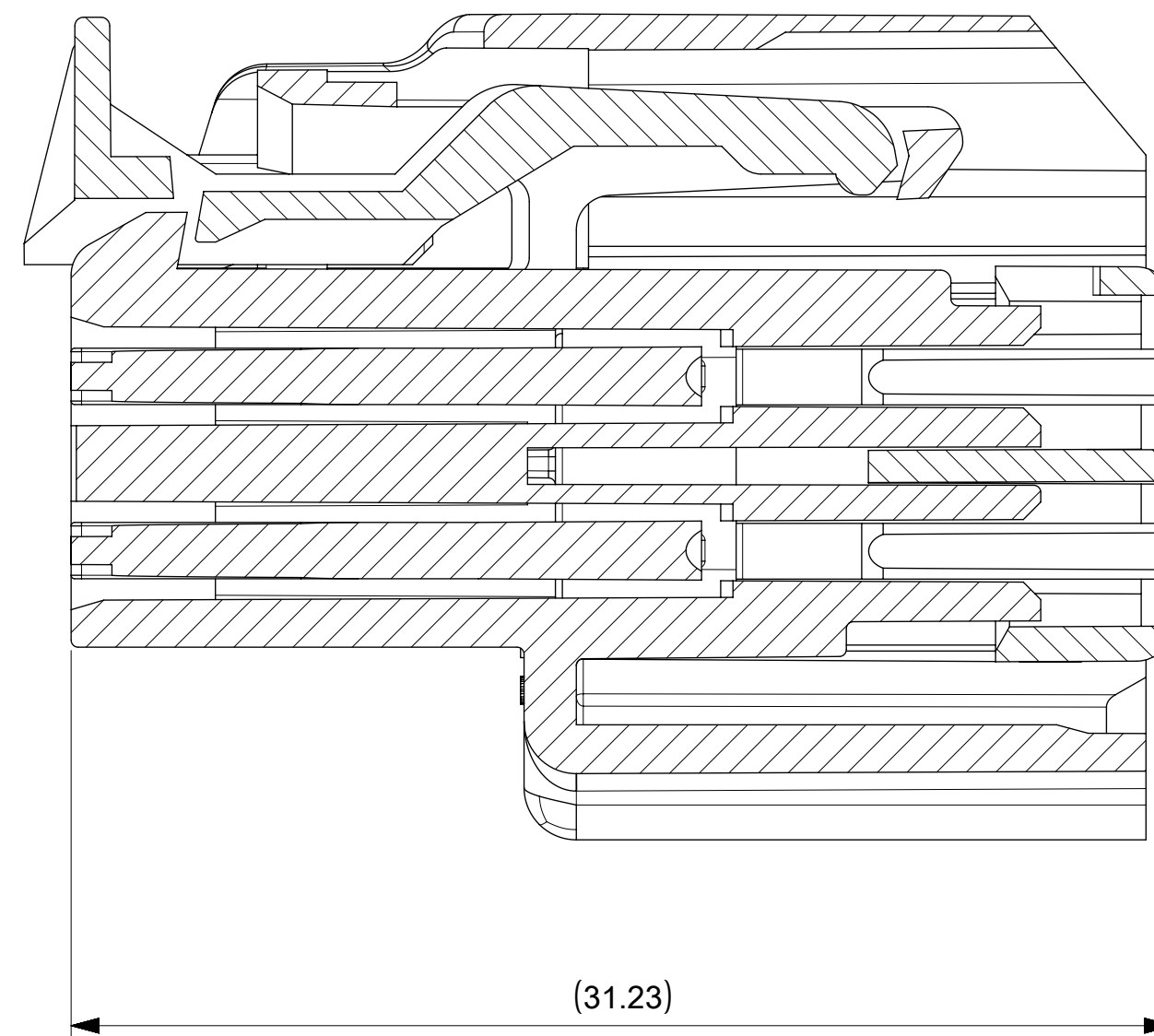
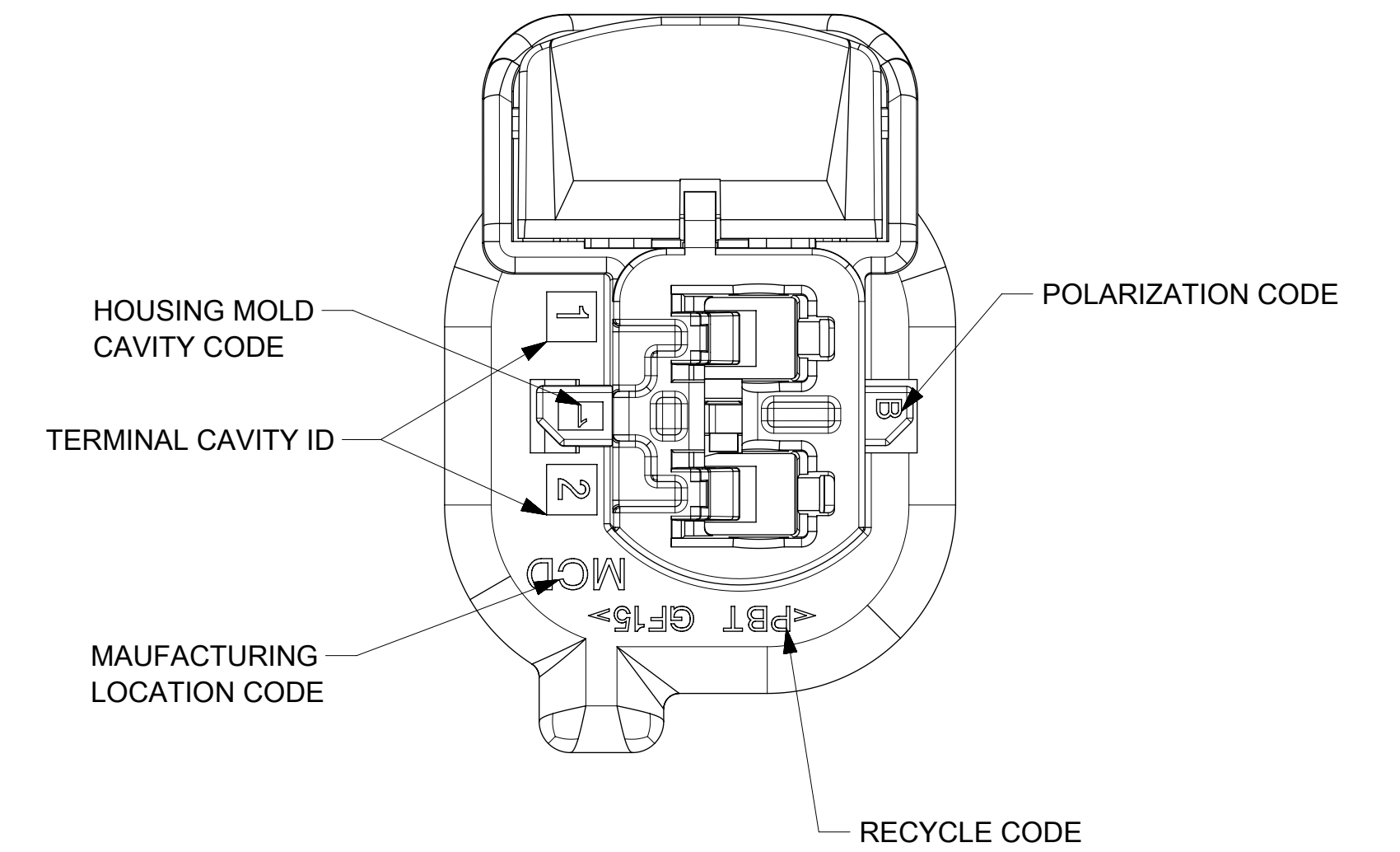
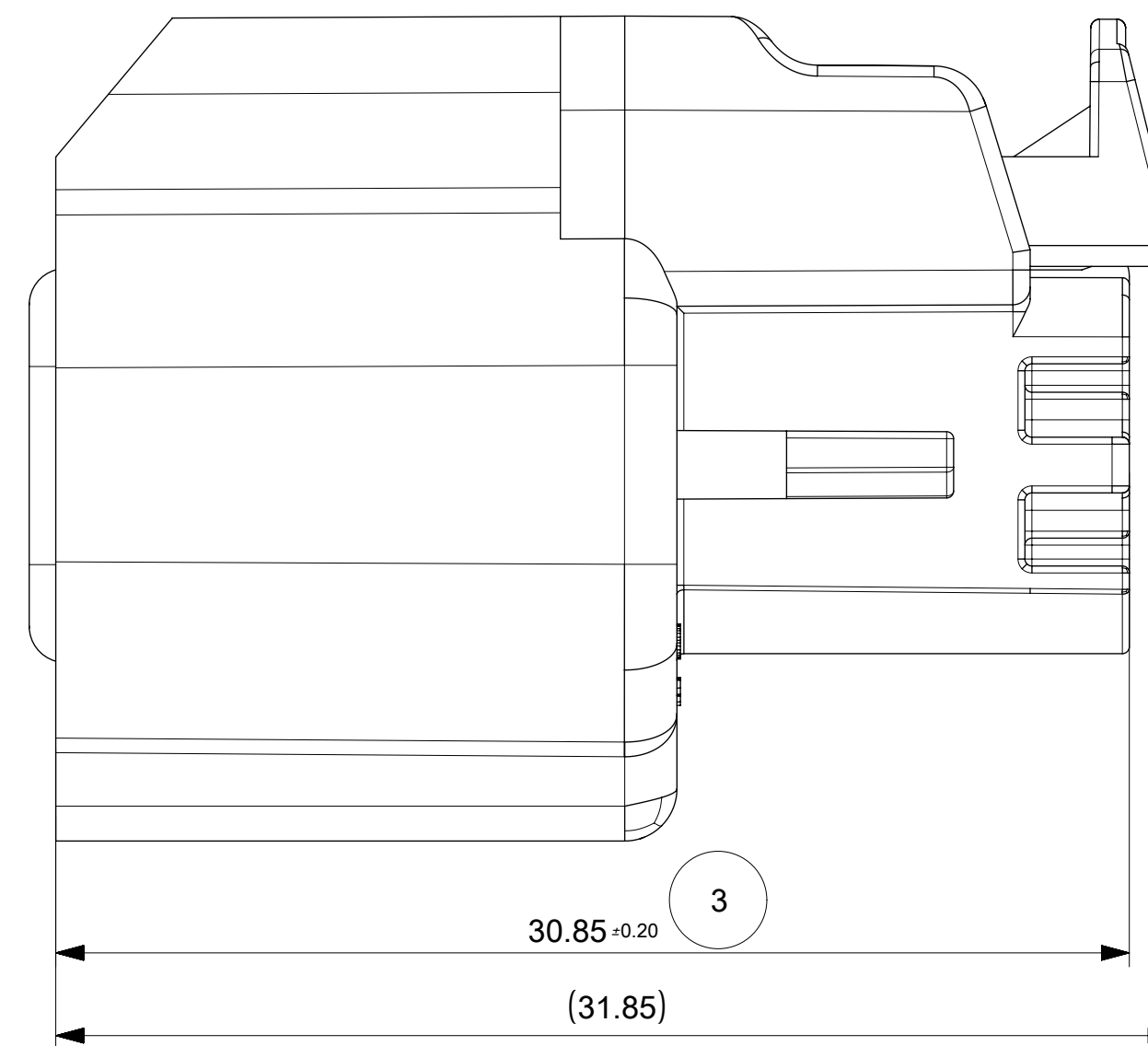
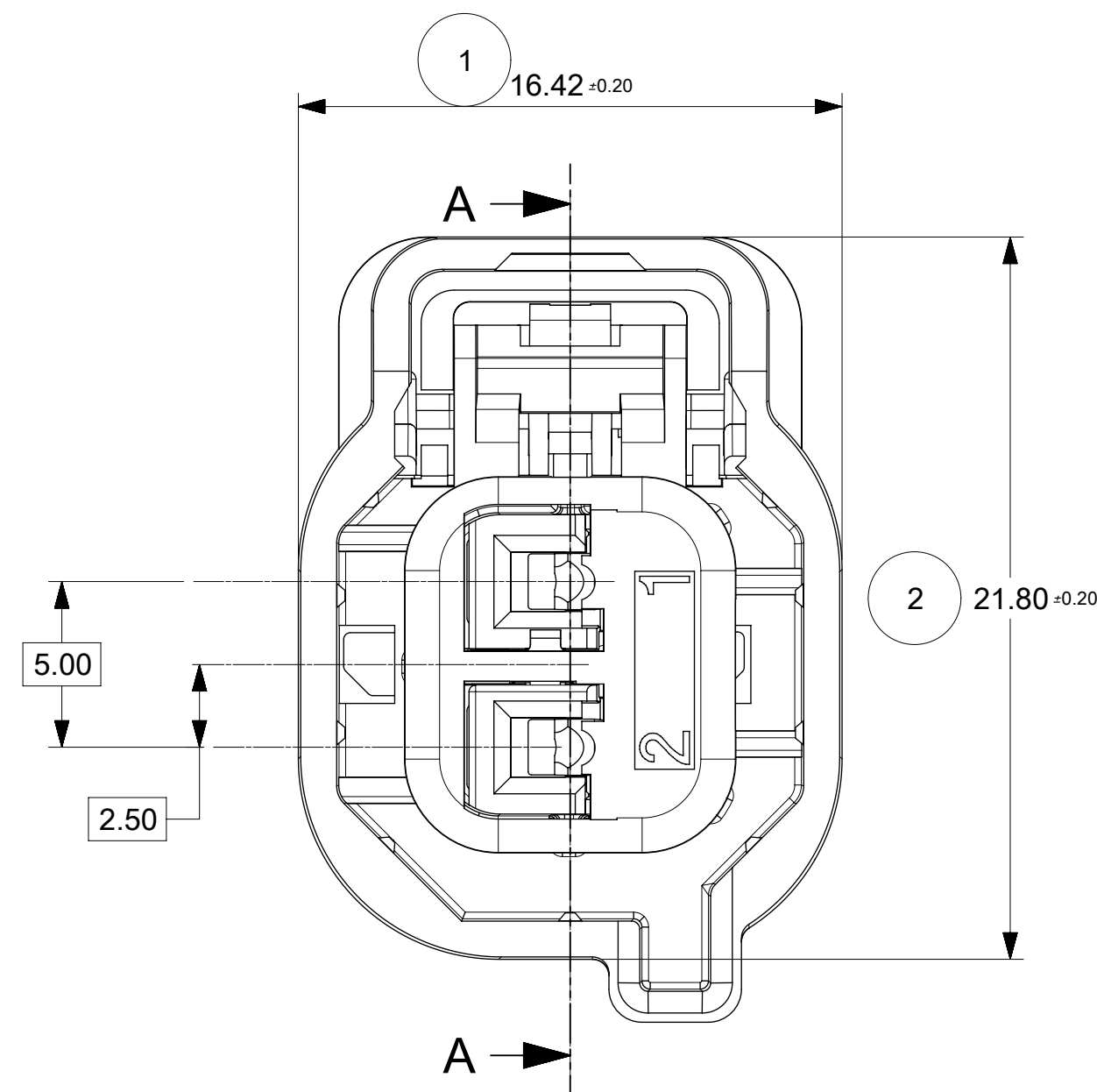
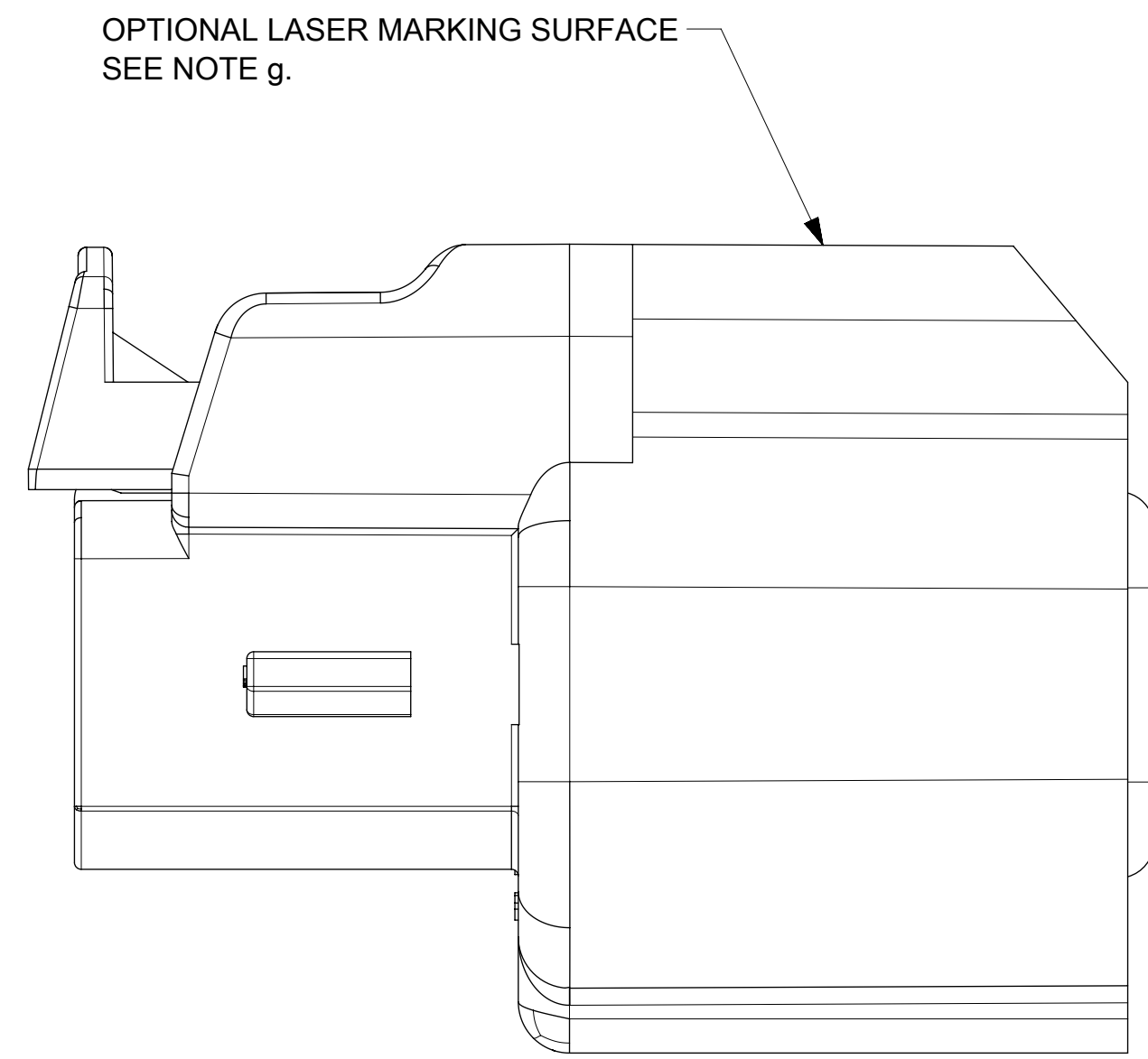

TPA SHOWN IN THE PRE-STAGED POSITION SECTION A-A

CONNECTOR POLARIZATION F BLACK	1480320006				F	CPA	TPA	DESIGN CONCEPT
CONNECTOR POLARIZATION E BLACK	1480320005				E	CPA	TPA	OK TO TOOL
CONNECTOR POLARIZATION D NATURAL	1480320004			D		CPA	TPA	DESIGN CONCEPT
CONNECTOR POLARIZATION C BLACK	1480320003			C		CPA	TPA	OK TO TOOL
CONNECTOR POLARIZATION B LIGHT GRAY	1480320002			B		CPA	TPA	OK TO TOOL
CONNECTOR POLARIZATION A BLACK	1480320001			A		CPA	TPA	DESIGN CONCEPT
ASSEMBLY DESCRIPTION	ASSEMBLY PART NUMBER							PRODUCTION TOOL STATUS

DESCRIPTION	COLOR	MATERIAL	STATUS
TPA	NATURAL	PBT GF30	OK TO TOOL
CPA	RED	PBT GF30	OK TO TOOL
HOUSING POLARIZATION F	BLACK	PBT GF15	DESIGN CONCEPT
HOUSING POLARIZATION E	BLACK	PBT GF15	OK TO TOOL
HOUSING POLARIZATION D	NATURAL	PBT GF15	DESIGN CONCEPT
HOUSING POLARIZATION C	BLACK	PBT GF15	OK TO TOOL
HOUSING POLARIZATION B	LIGHT GRAY	PBT GF15	OK TO TOOL
HOUSING POLARIZATION A	BLACK	PBT GF15	DESIGN CONCEPT

BOM AND APPLICABLE COMPONENT TABLE

<p>QUALITY SYMBOLS</p> <p>▽ = 0</p> <p>▽ = 0</p> <p>▽ = 0</p> <p>▽ = 0</p> <p>▽ = 0</p> <p>▽ = 0</p> <p>▽ = 0</p> <p>▽ = 0</p> <p>▽ = 0</p> <p>▽ = 0</p> <p>▽ = 0</p>	THIS DRAWING CONTAINS INFORMATION THAT IS PROPRIETARY TO MOLEX ELECTRONIC TECHNOLOGIES, LLC AND SHOULD NOT BE USED WITHOUT WRITTEN PERMISSION				<p>molex</p>	
	GENERAL TOLERANCES (UNLESS SPECIFIED)		DIMENSION UNITS	SCALE		
	ANGULAR TOL ± 3.0 °		MM	5:1	CUSTOMER DRAWING	
	4 PLACES ±		DRWN BY	DATE	SERIES MATERIAL NUMBER CUSTOMER	
3 PLACES ±		XBTANG	2016/08/22	148032	SEE BOM	GENERAL MARKET
2 PLACES ± 0.1		CHK'D BY	DATE	DOCUMENT NUMBER DOC TYPE DOC PART SHEET NUMBER		
1 PLACE ± 0.3		XBTANG	2016/09/20	1480324100	CD	000 3 OF 4
0 PLACES ±		APPR BY	DATE			
DRAFT WHERE APPLICABLE MUST REMAIN WITHIN DIMENSIONS		JDENG02	2016/09/26			
DRAWING SIZE		THIRD ANGLE PROJECTION				
A1						

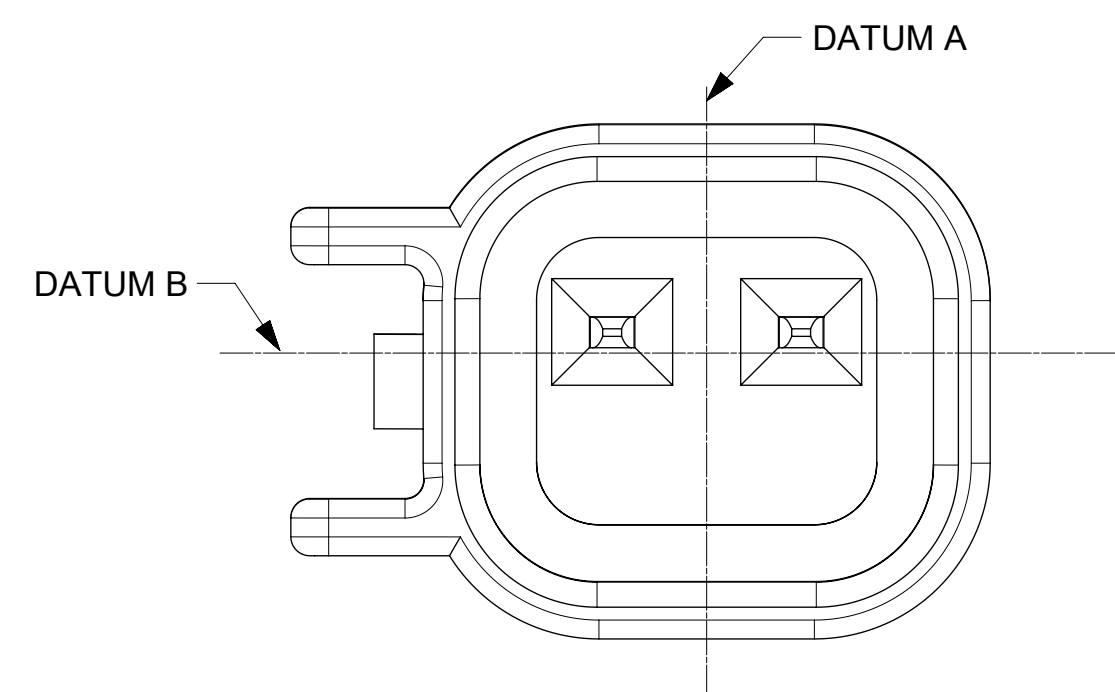

OPTION A

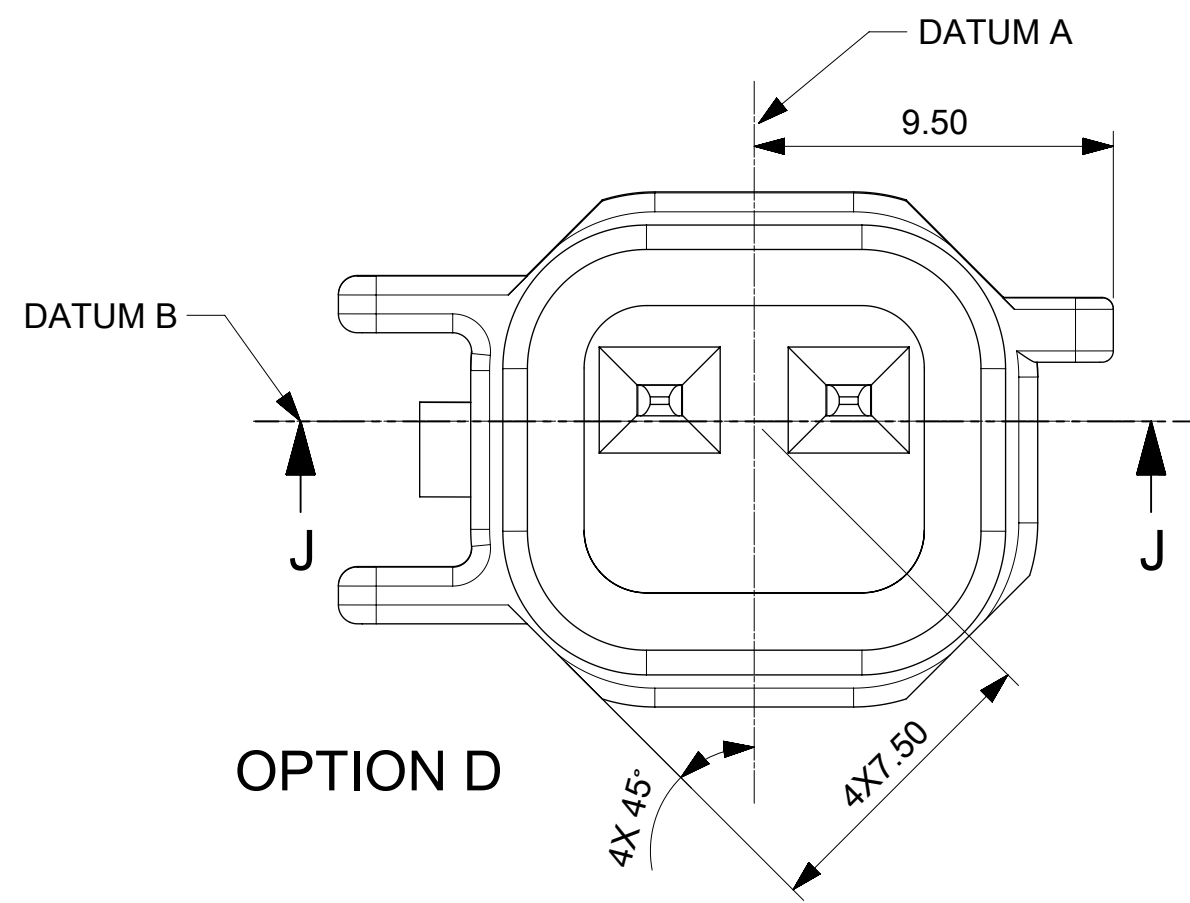

OPTION D

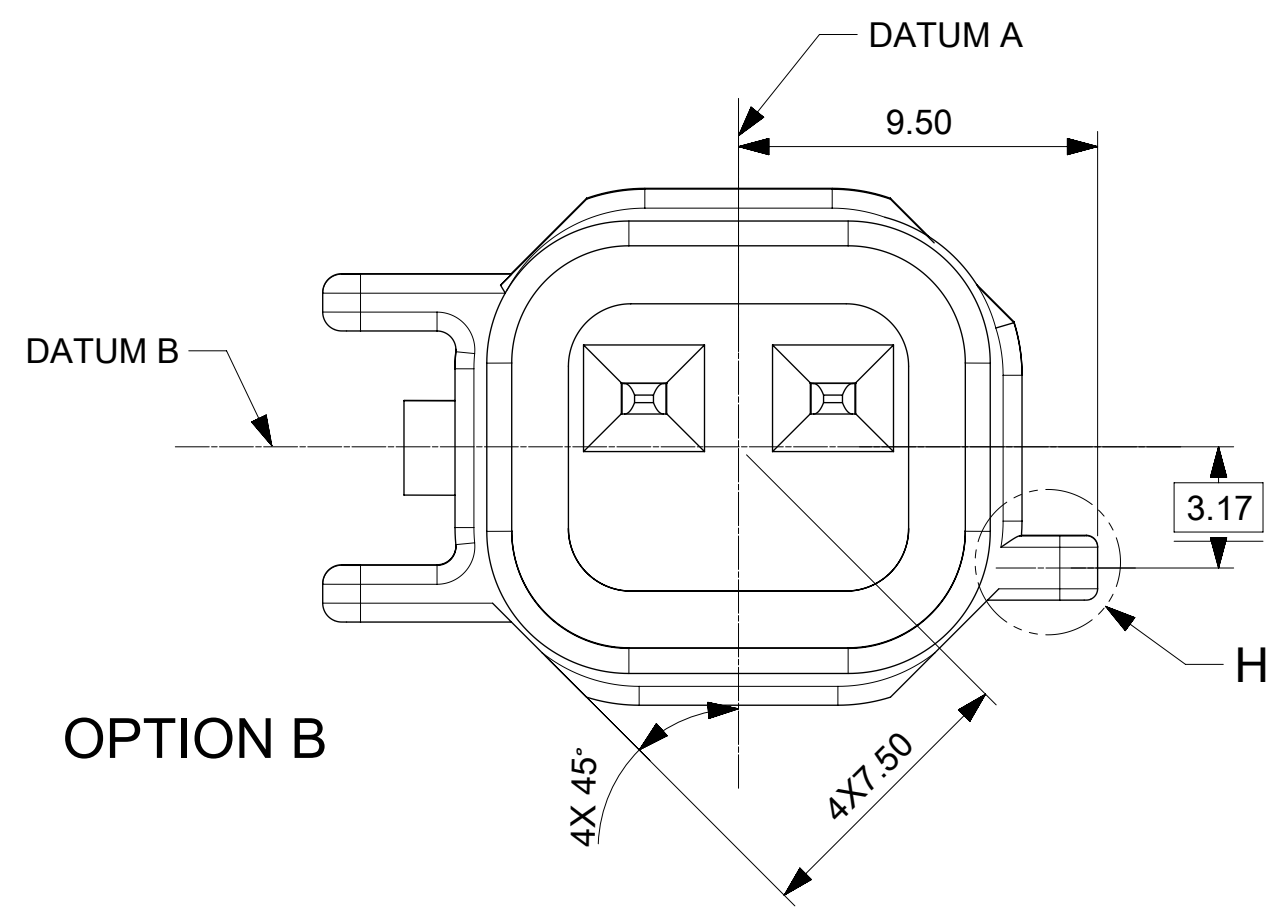

OPTION B

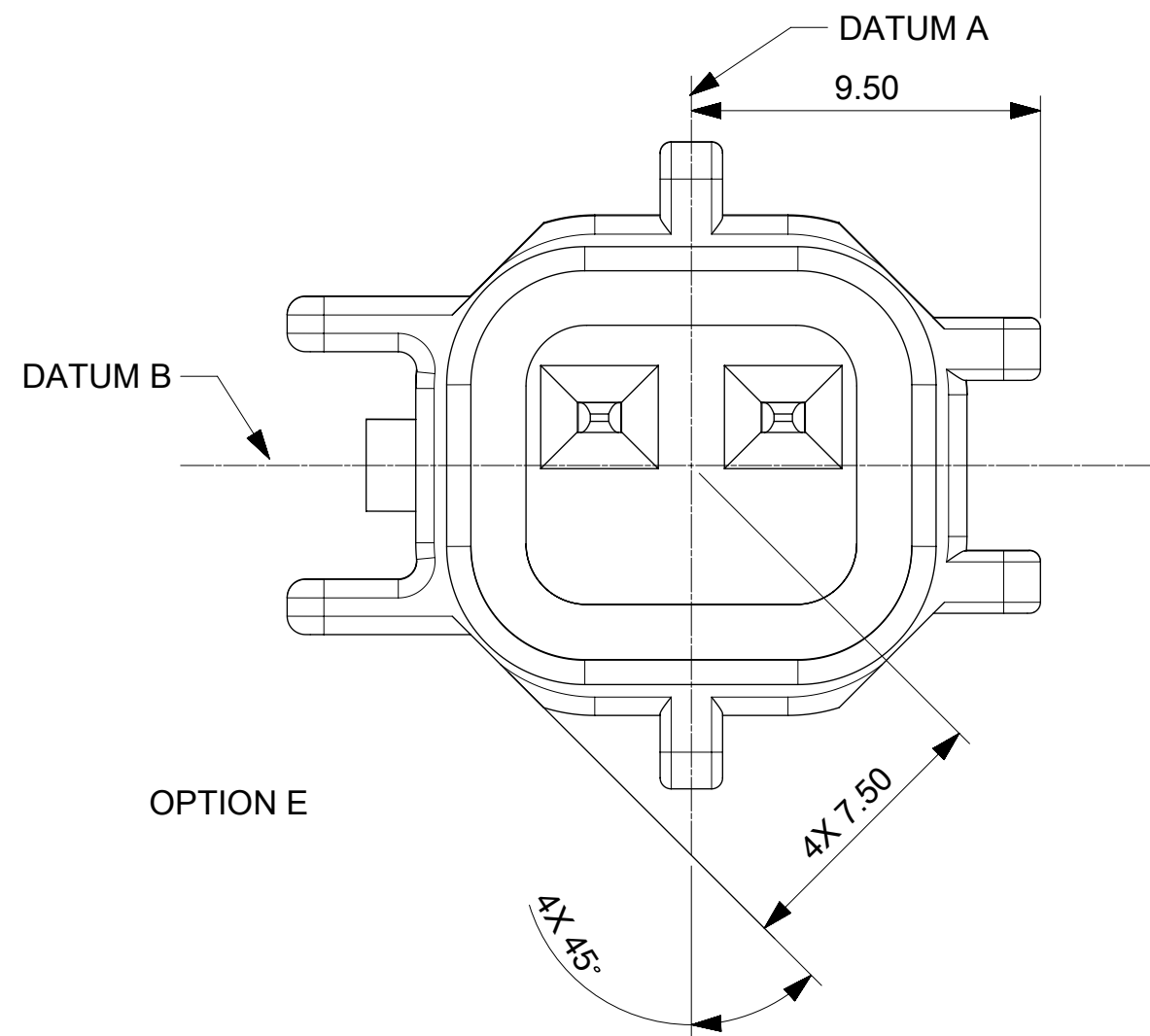

OPTION E

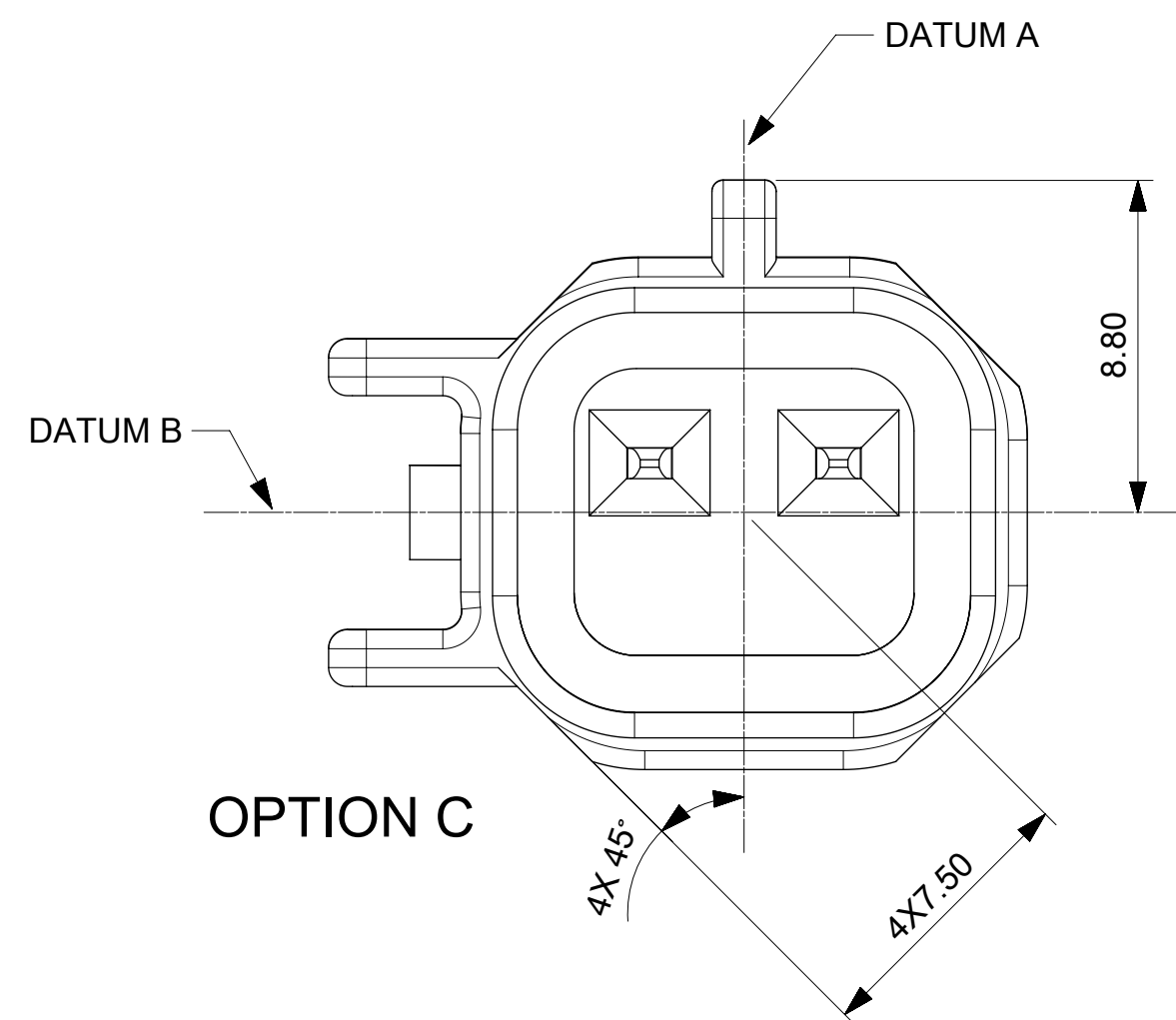

OPTION C

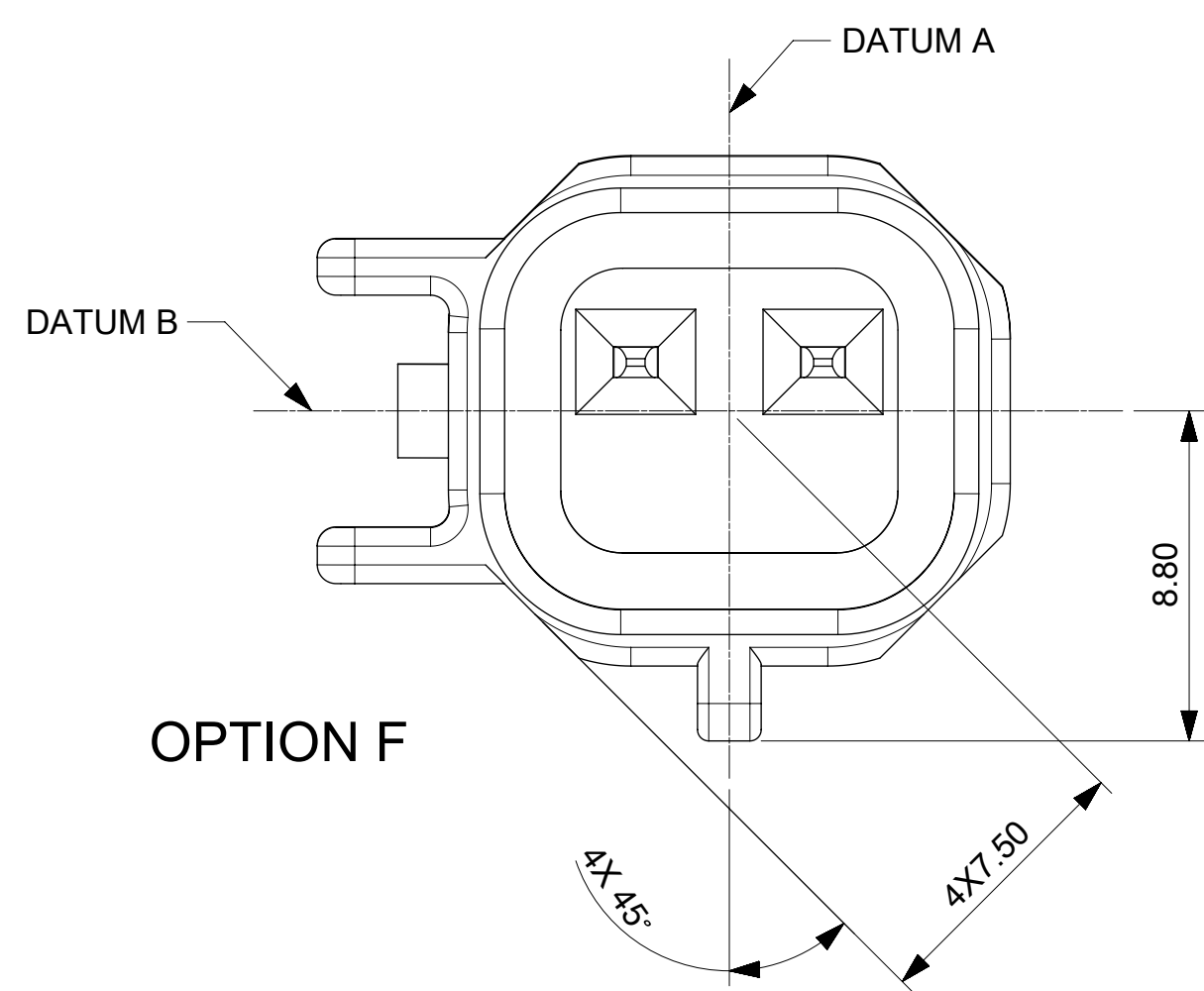

OPTION F

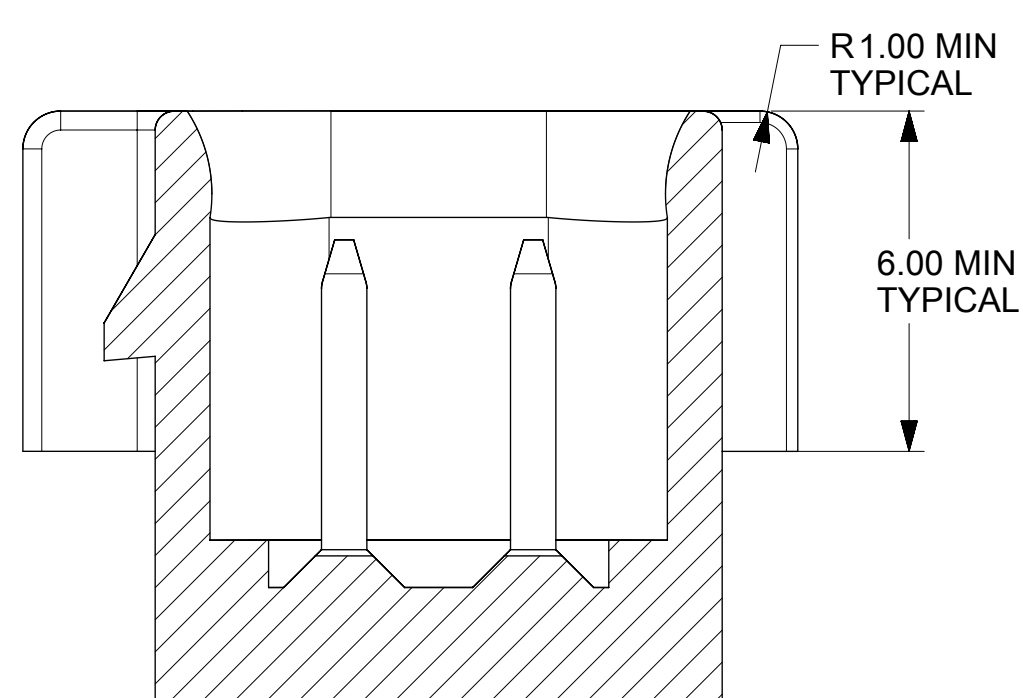

SECTION J-J

SEE KEYING OPTION VIEWS FOR POSITIONS

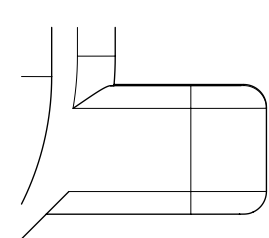

DETAIL H
SCALE 10:1
TYPICAL
SEE KEYING OPTION VIEWS FOR POSITIONS

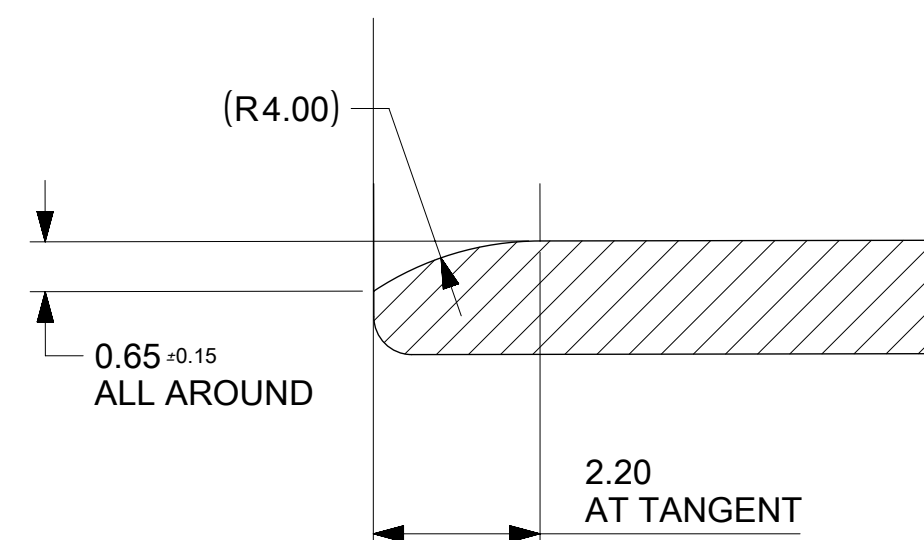

DETAIL G
SCALE 10:1

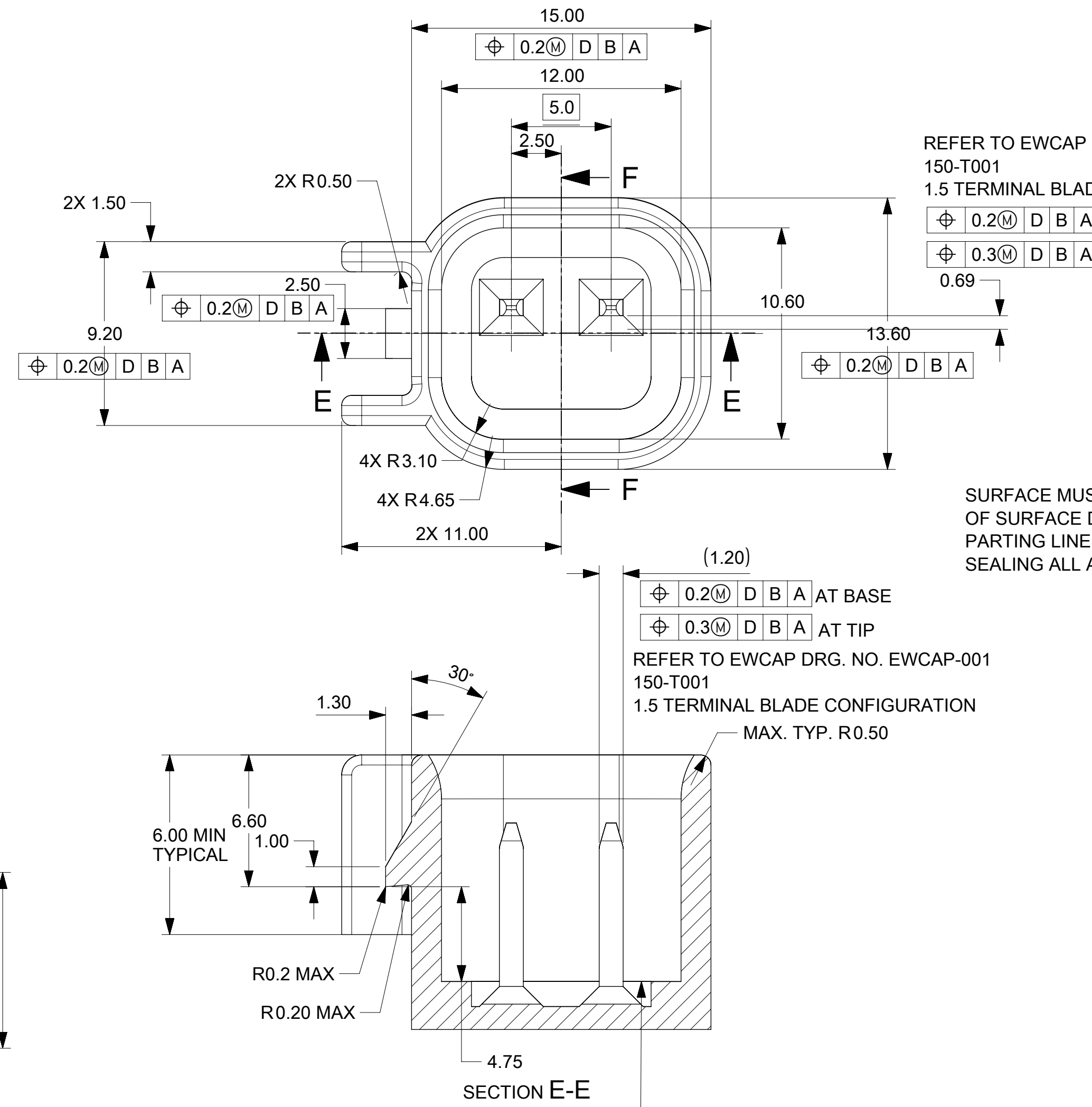

REFER TO EWCAP DRG. NO. EWCAP-001
150-T001
1.5 TERMINAL BLADE CONFIGURATION

$\phi 0.2 \text{ (M)}$ D B A AT BASE
 $\phi 0.3 \text{ (M)}$ D B A AT TIP

$\phi 0.2 \text{ (M)}$ D B A AT BASE
 $\phi 0.3 \text{ (M)}$ D B A AT TIP

REFER TO EWCAP DRG. NO. EWCAP-001
150-T001
1.5 TERMINAL BLADE CONFIGURATION

MAX. TYP. R0.50

CONSTRUCTION BELOW THIS SURFACE
IS NOT CONTROLLED BY EWCAP. NO PLASTIC
FEATURES MAY EXTEND ABOVE THIS SURFACE

PACKAGING FRAME

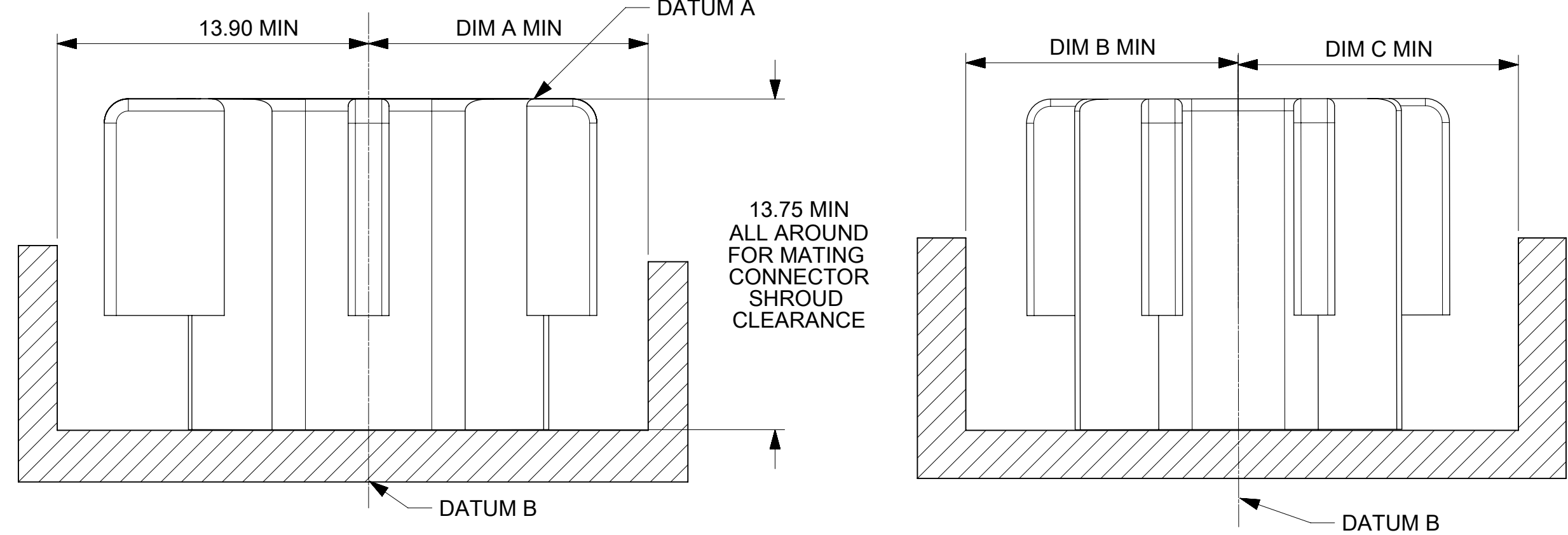

IF A HEADER IS RECESSED INTO A POCKET, THESE DIMENSIONS REPRESENT
THE MINIMUM CLEARANCE REQUIRED FOR THE MATING CONNECTOR SHROUD.

KEY OPTION	DIMENSIONS		
	DIM A	DIM B	DIM C
A	9.90	9.20	9.20
B	11.80	9.20	9.20
C	9.90	9.20	11.00
D	11.80	9.20	9.20
E	11.80	11.00	11.00
F	9.90	11.00	9.20

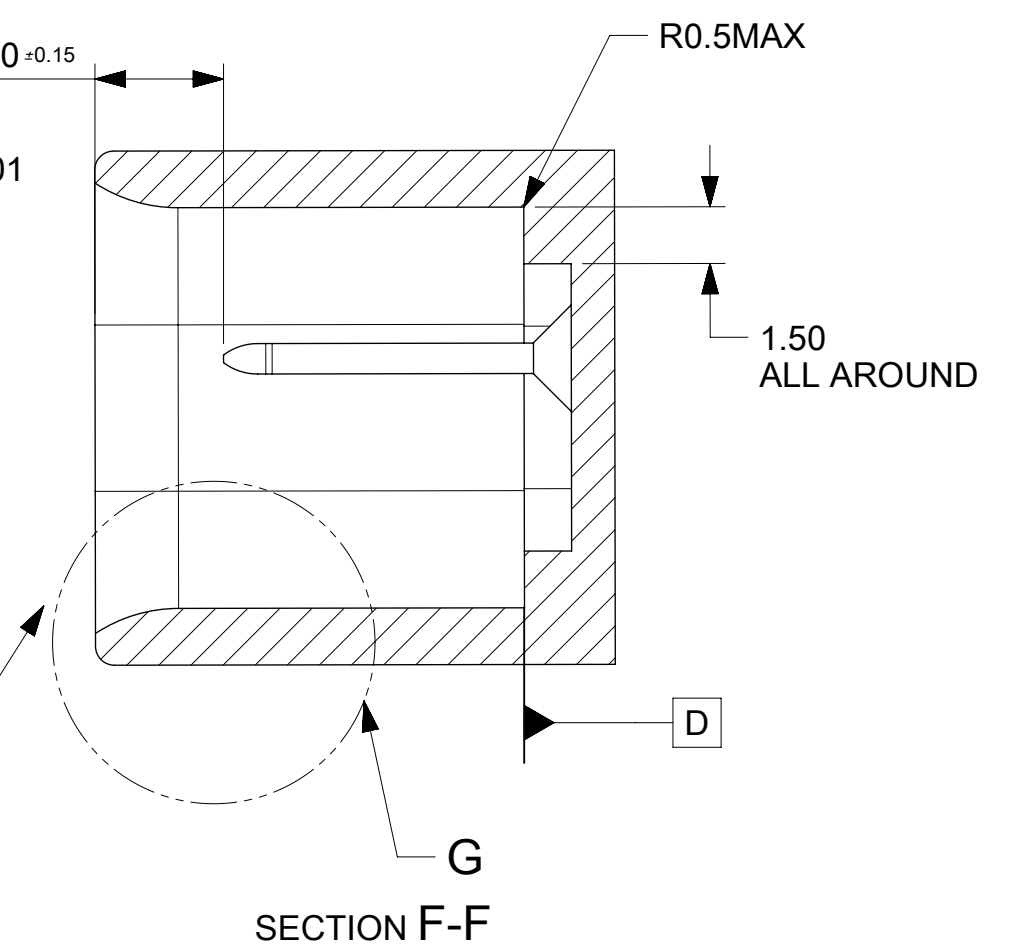

SECTION F-F

NOTES: UNLESS OTHERWISE SPECIFIED

- ALL DIMENSIONS SHOWN IN MILLIMETERS.
- DIMENSIONING AND TOLERANCING PER ASME Y14.5M-1994
- 0.25 RADII ON ALL CORNERS SHOWN SHARP.
- UNSPECIFIED RADII: 0.25 EXCEPT AS NOTED.
- STANDARD COLORS FOR POLARIZATION (SEE CHART).
DEVIATION REQUIRES APPROVAL OF AUTHORIZED PERSON.
- REFER TO SAE/USCAR 12 CONNECTOR GUIDELINES
FOR ADDITIONAL REQUIREMENTS.
- EXCEPT WHERE NOTED, DRAFT ON OUTSIDE SURFACES IS PERMISSIBLE
WITHIN TOLERANCE.
- SYMBOL INDICATES DRAFT DIRECTION.
- FOR TERMINAL MATERIAL, DIMENSIONAL, AND COATING REQUIREMENTS
AND ANY BLADE TERMINAL DESIGN INFORMATION NOT SHOWN ON THIS
DRAWING SEE EWCAP DWG. NO. EWCAP-001
- A FULL SHROUD ON THE MATING CONNECTOR IS REQUIRED
TO ENSURE THAT THE CONNECTOR-HEADER POLARIZATION
FEATURES (OPTIONS A THRU H) WILL FUNCTION. THE FULL
SHROUD ALSO PREVENTS SCOOP DAMAGE TO THE HEADER
PINS. REFER TO SAE/USCAR-12 CONNECTOR DESIGN
GUIDE LINES FOR ADDITIONAL INFORMATION.
- REFER TO USCAR/EWCAP PART LIST AS FOUND ON WEBSITE
<http://www.uscarteams.org>
- THIS IS A 100% CAD GENERATED PART. THE CAT MATHEMATICAL DATA
IS THE MASTER FOR THIS PART. FOR DIMENSIONAL OR ANY INFORMATION
NOT SHOWN ON THIS DRAWING, ANALYZE THE CAD MODEL.

<p>QUALITY SYMBOLS</p> <p></p>				<p>THIS DRAWING CONTAINS INFORMATION THAT IS PROPRIETARY TO MOLEX ELECTRONIC TECHNOLOGIES, LLC AND SHOULD NOT BE USED WITHOUT WRITTEN PERMISSION</p>			
<p>DRWN BY: 2016/11/23</p> <p>CHK'D: 2016/12/21</p> <p>EC NO: 110742</p> <p>DRWN: XBTANG</p> <p>CHK'D: JDENG02</p> <p>REV: APPR: JDENG02</p>		<p>GENERAL TOLERANCES (UNLESS SPECIFIED)</p> <p>ANGULAR TOL $\pm 3.0^\circ$</p> <p>4 PLACES \pm</p> <p>3 PLACES \pm</p> <p>2 PLACES ± 0.1</p> <p>1 PLACE ± 0.3</p> <p>0 PLACES \pm</p> <p>DRAFT WHERE APPLICABLE MUST REMAIN WITHIN DIMENSIONS</p>		<p>DIMENSION UNITS: MM</p> <p>SCALE: 5:1</p> <p>DRWN BY: XBTANG</p> <p>DATE: 2016/08/22</p> <p>CHK'D BY: XBTANG</p> <p>DATE: 2016/09/20</p> <p>APPR BY: JDENG02</p> <p>DATE: 2016/09/26</p> <p>DRAWING SIZE: A1</p> <p>THIRD ANGLE PROJECTION</p>		<p>molex</p> <p>GM2W UNSEAL SPEAKER ASSEMBLY SALES DRAWING</p> <p>CUSTOMER DRAWING</p> <p>SERIES: 148032</p> <p>MATERIAL NUMBER: SEE BOM</p> <p>CUSTOMER: GENERAL MARKET</p> <p>DOCUMENT NUMBER: 1480324100</p> <p>DOC TYPE: CD</p> <p>DOC PART: 000</p> <p>SHEET NUMBER: 4 OF 4</p>	