

| MATERIAL NUMBER | POSITION NUMBER | DIM. A           | DIM. B           | DIM. C           | QUANTITY OF POLARIZING SLOTS | PANEL THICKNESS ACCOMMODATED |
|-----------------|-----------------|------------------|------------------|------------------|------------------------------|------------------------------|
| 439382201       | 6               | 20.00<br>[.787]  | 30.90<br>[1.216] | 41.30<br>[1.626] | 1                            | 1.30/1.76<br>[.051/.069]     |
| 439382202       | 8               | 30.00<br>[1.181] | 40.90<br>[1.610] | 51.30<br>[2.020] | 2                            |                              |
| 439382203       | 10              | 40.00<br>[1.575] | 50.90<br>[2.004] | 61.30<br>[2.413] | 2                            |                              |
| 439382204       | 12              | 50.00<br>[1.968] | 60.90<br>[2.398] | 71.30<br>[2.807] | 2                            |                              |
| 439382205       | 14              | 60.00<br>[2.362] | 70.90<br>[2.791] | 81.30<br>[3.201] | 2                            |                              |

**NOTES:**

1. MATERIAL: UNFILLED POLYESTER, U.L. 94V-0, COLOR: BLACK
2. FINISH: NONE
3. PRODUCT SPEC: PS-42815-001
4. THIS PART IS DESIGNED TO USE MALE CRIMP TERMINAL #42817
5. THIS PART IS DESIGNED TO USE T.P.A. #43980
6. THIS PART IS DESIGNED TO MATE WITH RECEPTACLE HOUSING #43914
7. SEE SHEET 2 FOR PANEL CUT-OUT DETAILS
8. POLARIZING SLOTS TO BE LOCATED BETWEEN CIRCUITS ON EITHER END OF HOUSING OF THE CIRCUIT 1 ROW AS SHOWN.  
EXCEPTION: THE 6 CIRCUIT HOUSING WILL HAVE A SINGLE SLOT ON THE CIRCUIT 1 END ONLY
9. AN "X" IS ENGRAVED AS SHOWN TO DESIGNATE THAT THE PART ACCOMMODATES A 1.30/1.76 PANEL THICKNESS
10. PARTS TO BE PACKAGED: 6~10 CKT PER PK-43938-001, 12~14 CKT PER PK-45286-002

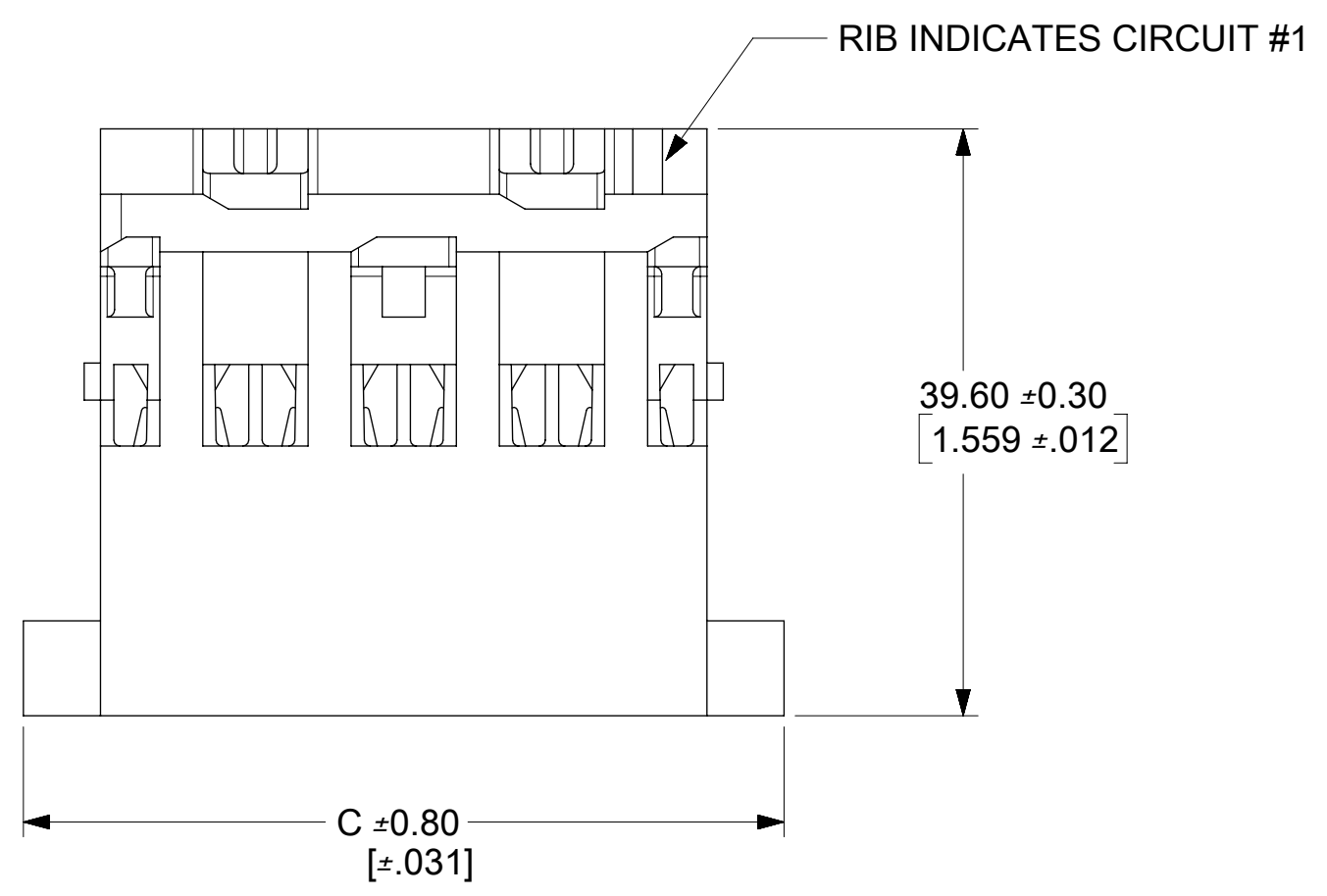

**THIS PRODUCT MUST NOT BE USED WITHOUT THE T.P.A.**

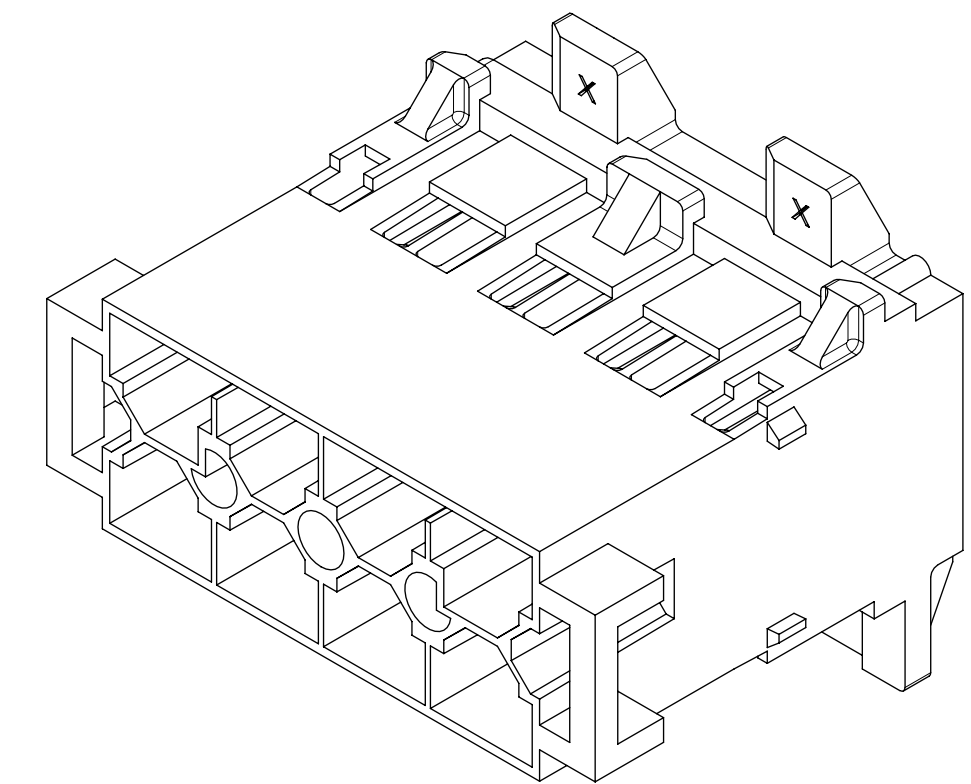
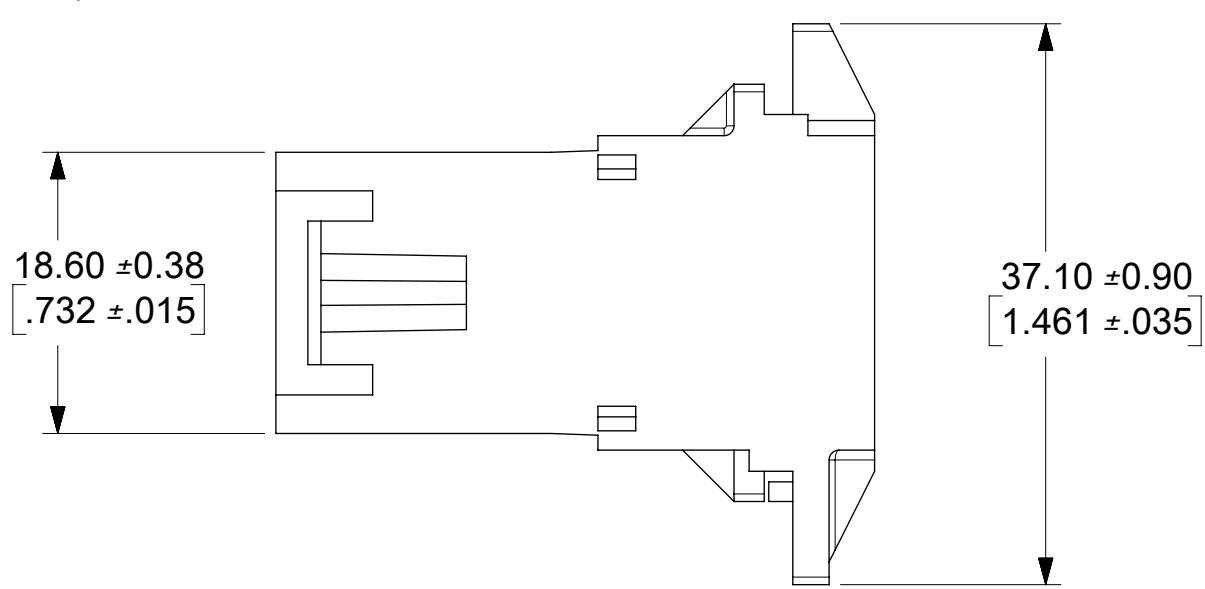
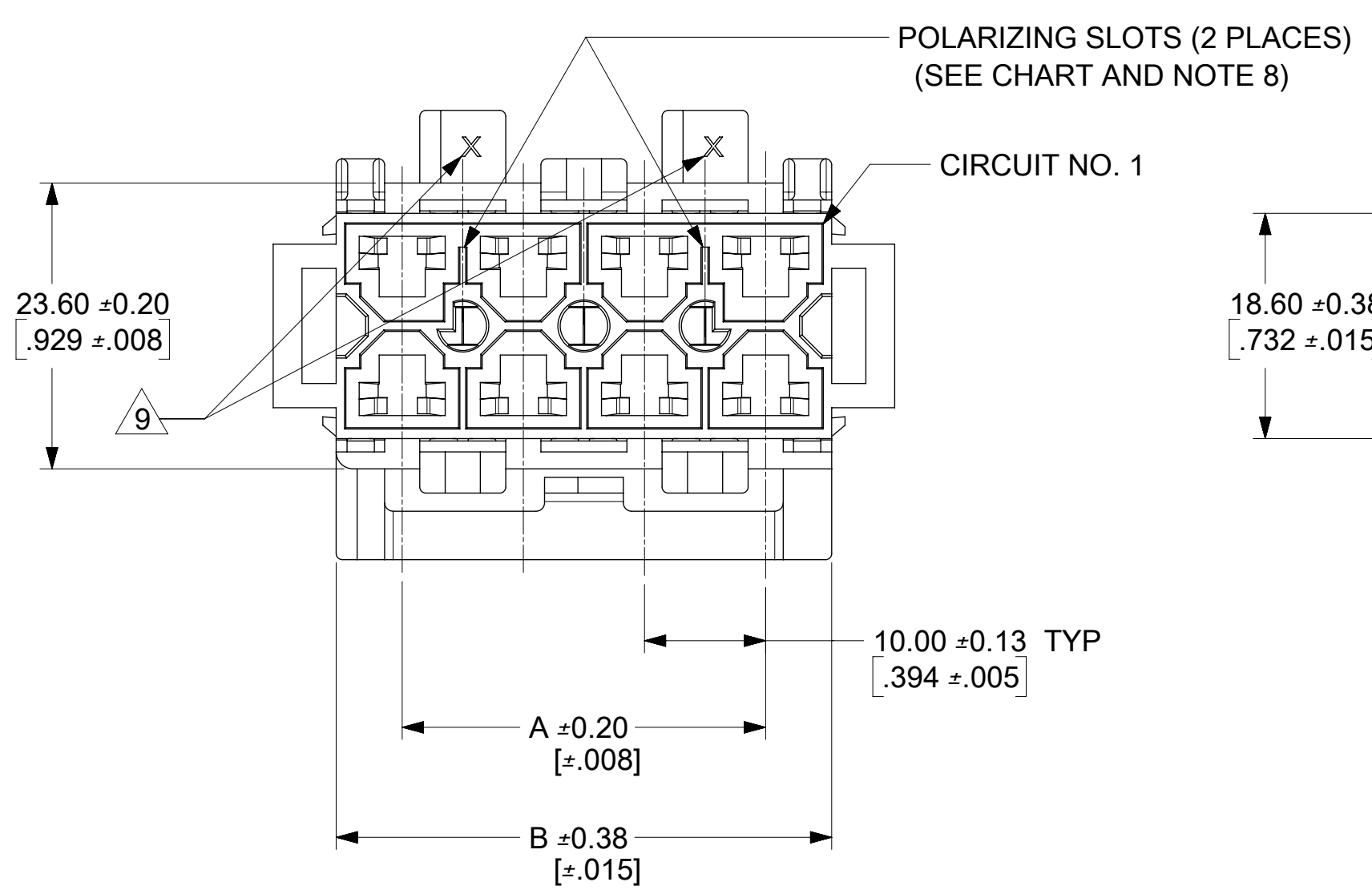

|   |  |                        |  |  |  |                   |  |                                       |  |
|---|--|------------------------|--|--|--|-------------------|--|---------------------------------------|--|
| THIS DRAWING CONTAINS INFORMATION THAT IS PROPRIETARY TO MOLEX ELECTRONIC TECHNOLOGIES, LLC AND SHOULD NOT BE USED WITHOUT WRITTEN PERMISSION |  |                        |  |  |  |                   |  |                                       |  |
| DIMENSION UNITS<br><b>IN/MM</b>   |  | SCALE<br><b>2:1</b>    |  | CURRENT REV DESC: 2 PLACES REMOVED<br>IN 6 CIRCUIT (MAT NO: 439382201) |  |                   |  | <b>molex</b>                          |  |
| GENERAL TOLERANCES<br>(UNLESS SPECIFIED)  |  |                        |  | EC NO: 651534  |  |                   |  |                                       |  |
| 4 PLACES ±  |  | MM                     |  | INCH   |  | DRWN: VIJAYS4     |  | 2020/11/18                            |  |
| 3 PLACES ±  |  |                        |  |  |  | CHK'D: SHRUTJ     |  | 2020/12/16                            |  |
| 2 PLACES ±  |  |                        |  |  |  | APPR: ISHWARG     |  | 2020/12/21                            |  |
| 1 PLACE ±   |  |                        |  |  |  | INITIAL REVISION: |  |                                       |  |
| 0 PLACES ±  |  |                        |  |  |  | DRWN: JDFOX       |  | 2014/08/21                            |  |
| ANGULAR TOL ± 0.5°  |  |                        |  |  |  | APPR: FSMITH      |  | 2014/08/25                            |  |
| DRAFT WHERE APPLICABLE<br>MUST REMAIN<br>WITHIN DIMENSIONS  |  | THIRD ANGLE PROJECTION |  | DRAWING  |  | SERIES            |  | DOCUMENT NUMBER                       |  |
|   |  |                        |  | C-SIZE   |  | 43938             |  | SD-43938-003                          |  |
|   |  |                        |  |  |  |                   |  | DOC TYPE DOC PART REVISION            |  |
|   |  |                        |  |  |  |                   |  | PSD 001 B2                            |  |
|   |  |                        |  |  |  |                   |  | PRODUCT CUSTOMER DRAWING              |  |
|   |  |                        |  |  |  |                   |  | MATERIAL NUMBER CUSTOMER SHEET NUMBER |  |
|   |  |                        |  |  |  |                   |  | SEE CHART GENERAL MARKET 1 OF 2       |  |

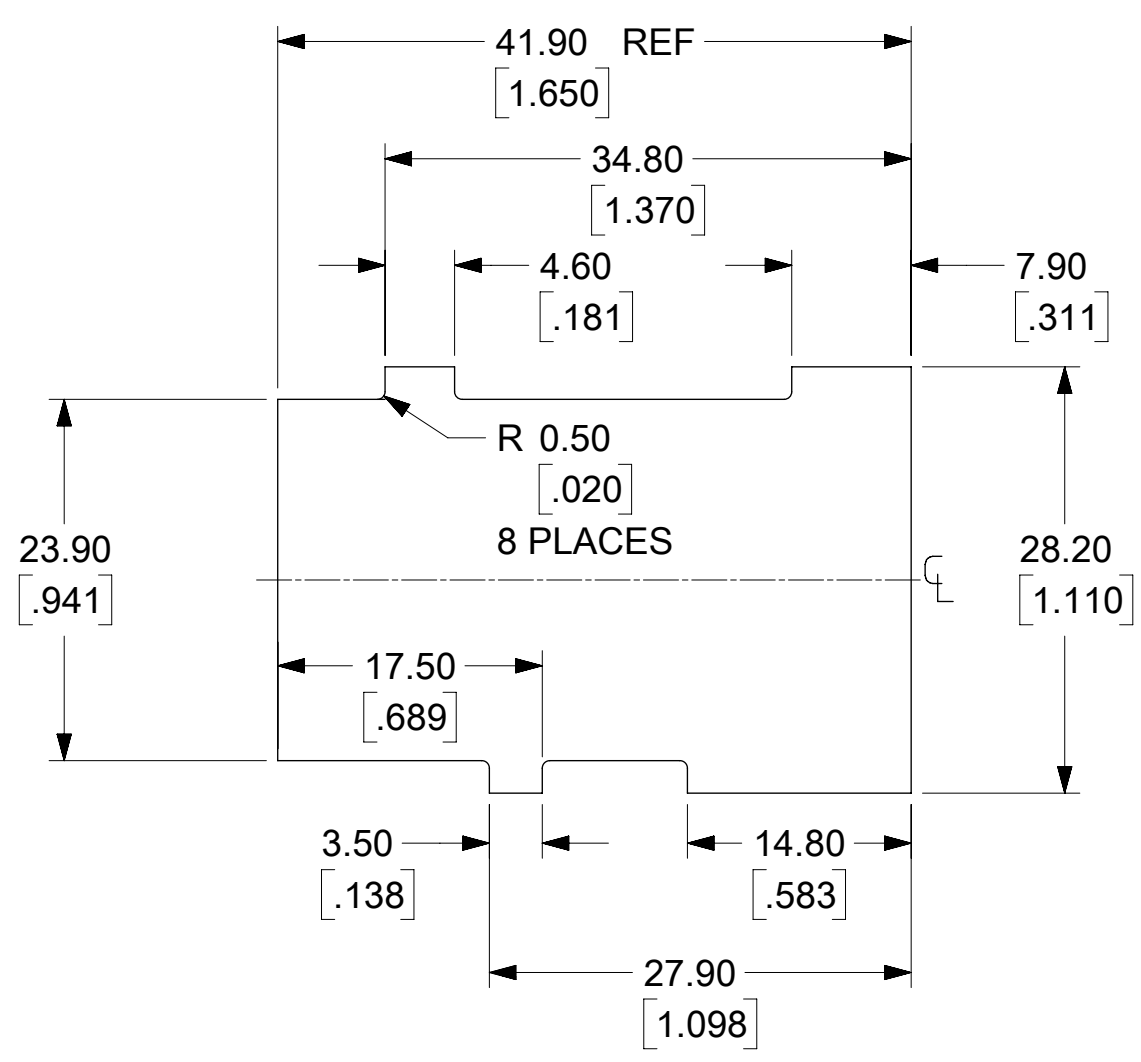

MATERIAL NO.:  
439382201  
6 CIRCUIT

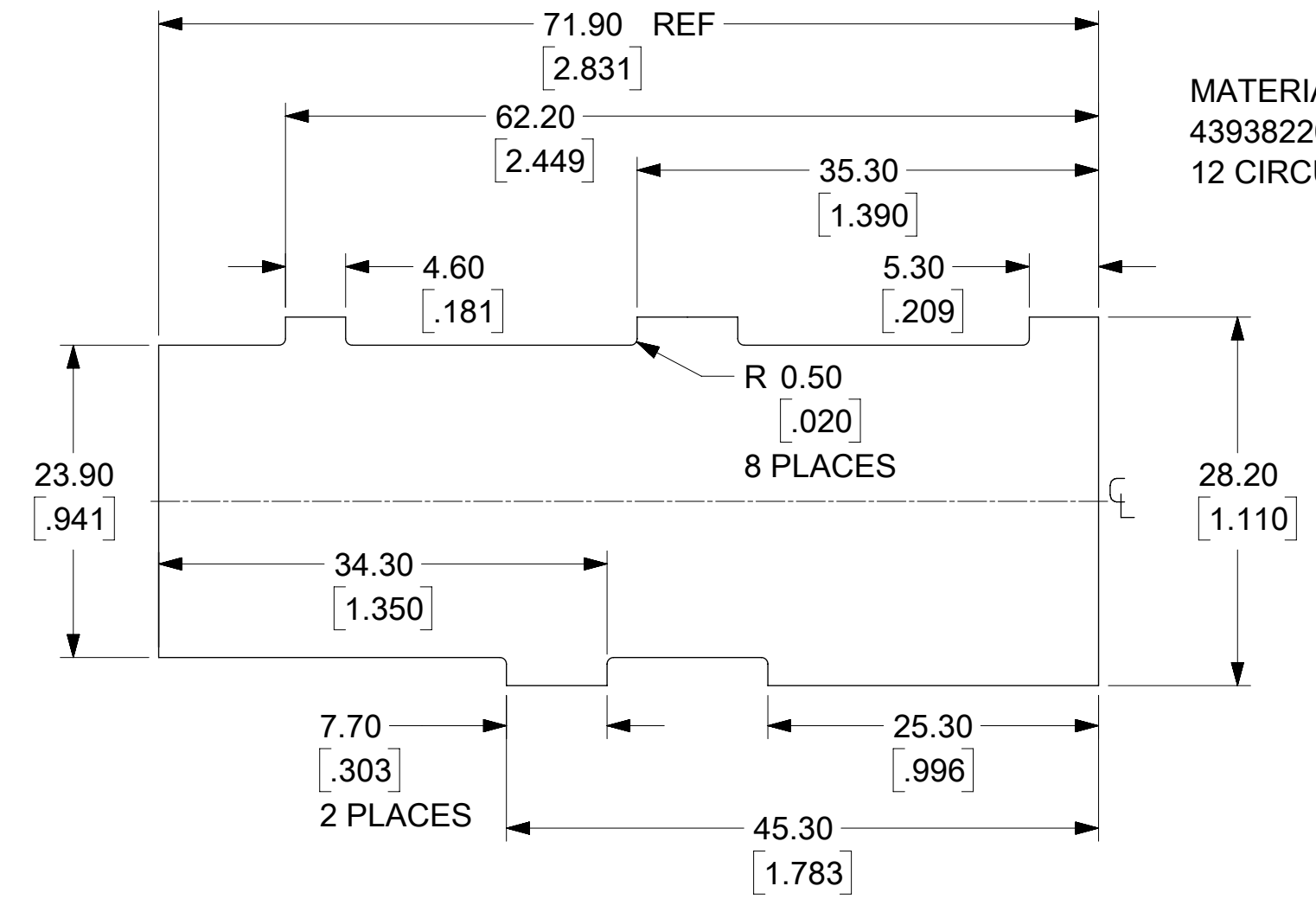

MATERIAL NO.:  
439382204  
12 CIRCUIT

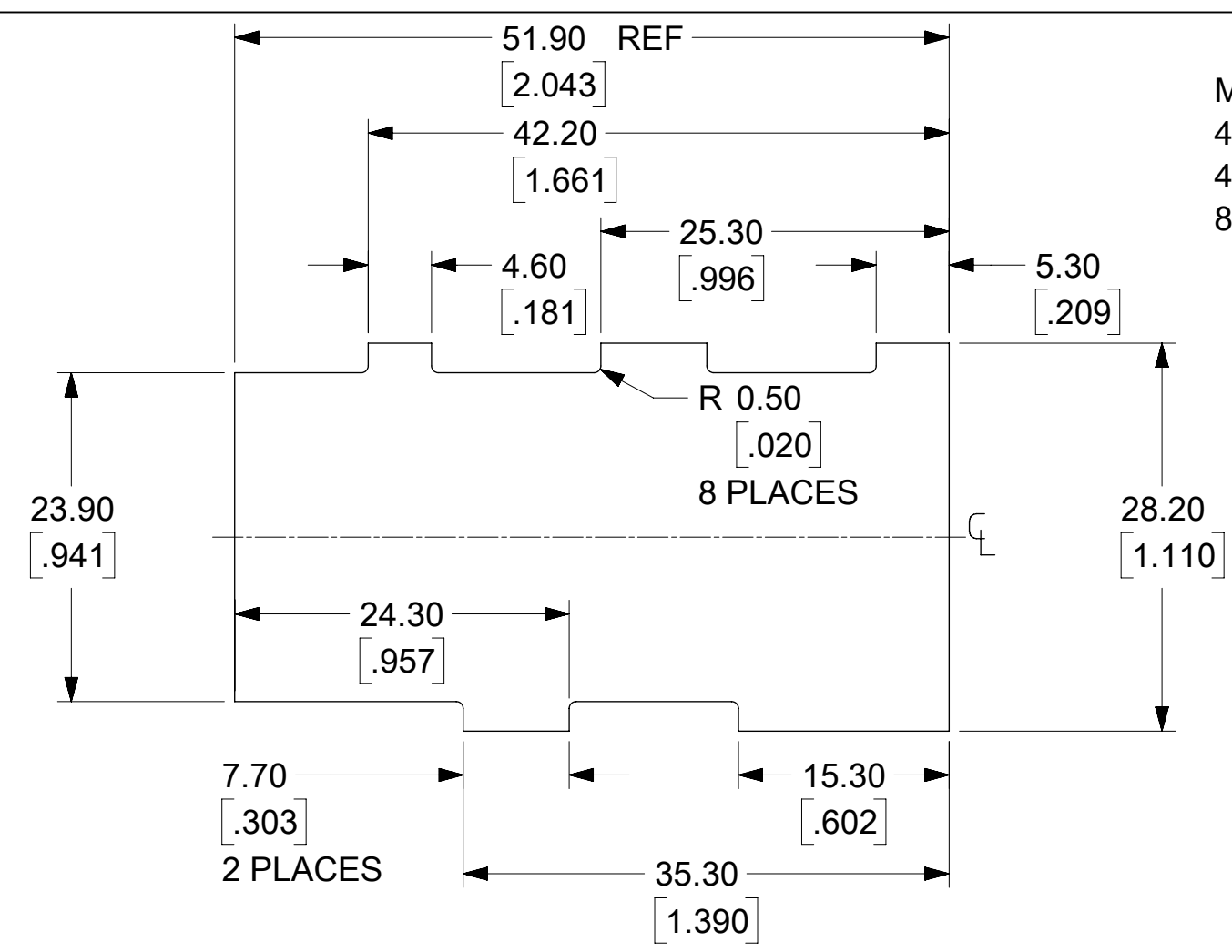

MATERIAL NO.:  
439381102  
439382202  
8 CIRCUIT

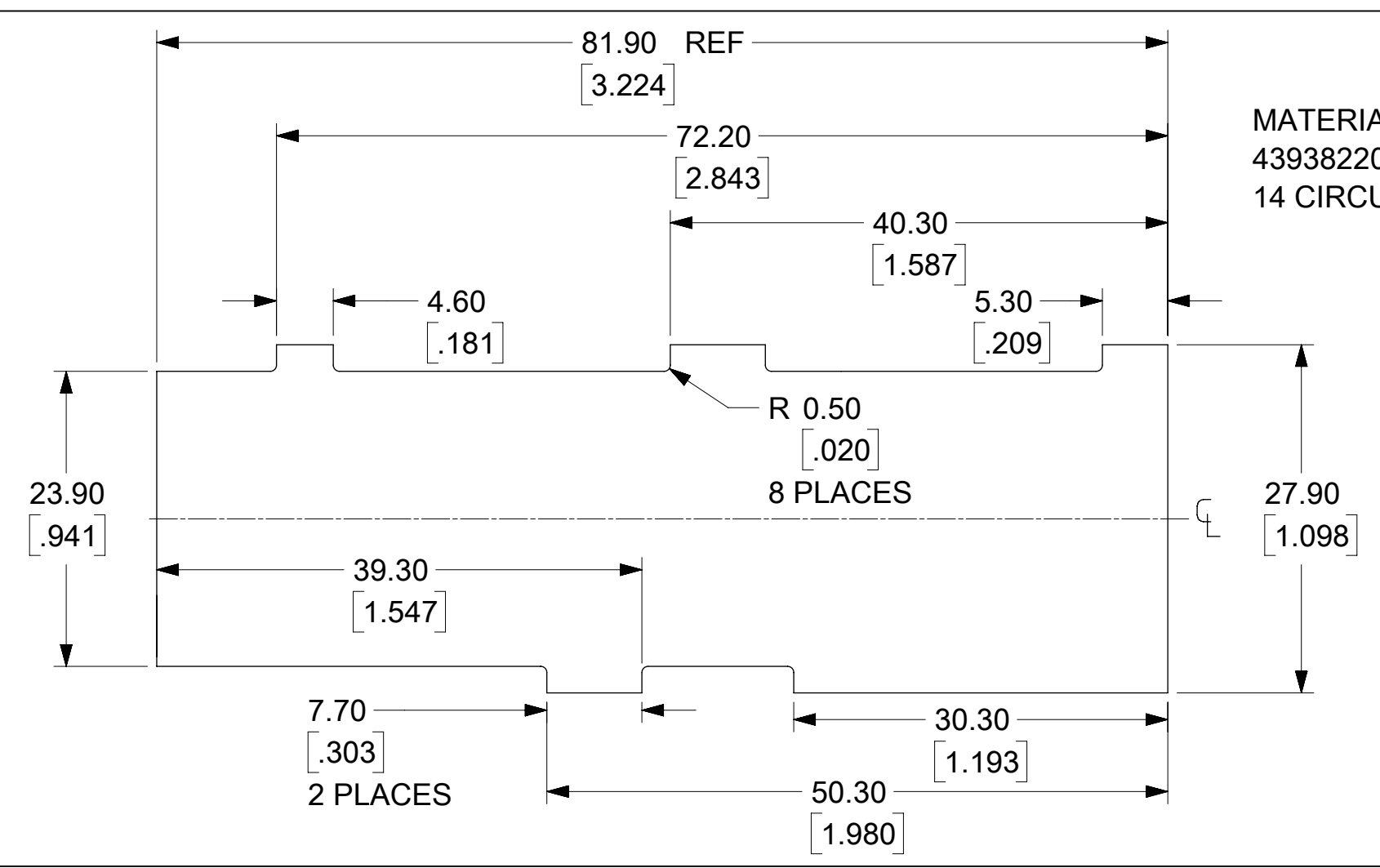

MATERIAL NO.:  
439382205  
14 CIRCUIT

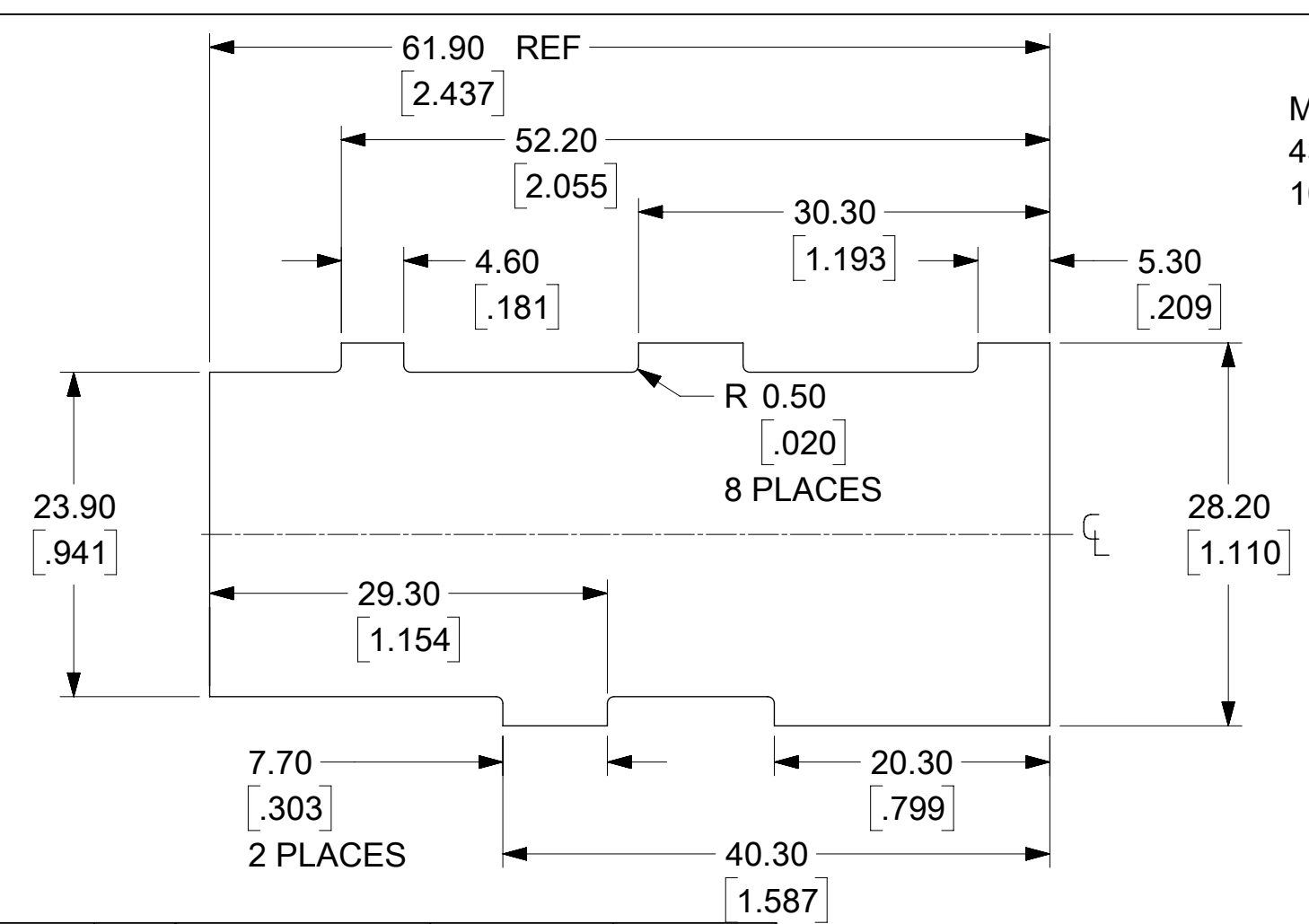

MATERIAL NO.:  
439382203  
10 CIRCUIT

PANEL OPENINGS SHOWN FROM OUTSIDE OF BOX.  
SEE CHART FOR PANEL THICKNESS

|   |  |       |  |   |  |                          |  |              |  |
|---|--|-------|--|---|--|--------------------------|--|--------------|--|
| THIS DRAWING CONTAINS INFORMATION THAT IS PROPRIETARY TO MOLEX ELECTRONIC TECHNOLOGIES, LLC AND SHOULD NOT BE USED WITHOUT WRITTEN PERMISSION |  |       |  |   |  |                          |  |              |  |
| DIMENSION UNITS   |  | SCALE |  | CURRENT REV/DESC: 2 PLACES REMOVED IN 6 CIRCUIT (MAT NO: 439382201) |  |                          |  |              |  |
| IN/MM   |  | 2:1   |  |   |  |                          |  |              |  |
| GENERAL TOLERANCES (UNLESS SPECIFIED)   |  |       |  | EC NO: 651534   |  |                          |  |              |  |
|   |  | MM    |  | INCH  |  | DRWN: VIJAYS4 2020/11/18 |  |              |  |
| 4 PLACES  |  | ±     |  | ±   |  | CHK'D: SHRUTJ 2020/12/16 |  |              |  |
| 3 PLACES  |  | ±     |  | ±   |  | APPR: ISHWARG 2020/12/21 |  |              |  |
| 2 PLACES  |  | ±     |  | ±   |  | INITIAL REVISION:        |  |              |  |
| 1 PLACE   |  | ±     |  | ±   |  | DRWN: JDFOX 2014/08/21   |  |              |  |
| 0 PLACES  |  | ±     |  | ±   |  | APPR: FSMITH 2014/08/25  |  |              |  |
| ANGULAR TOL ± 0.5°  |  |       |  | THIRD ANGLE PROJECTION  |  | DRAWING                  |  | SERIES       |  |
| DRAFT WHERE APPLICABLE MUST REMAIN WITHIN DIMENSIONS  |  |       |  |   |  | C-SIZE                   |  | 43938        |  |
| DOCUMENT STATUS   |  |       |  | DOC TYPE  |  | DOC PART                 |  | REVISION     |  |
| P1  |  |       |  | PSD   |  | 001                      |  | B2           |  |
| RELEASE DATE  |  |       |  | MATERIAL NUMBER   |  | CUSTOMER                 |  | SHEET NUMBER |  |
| 2020/12/21 15:07:08   |  |       |  | SEE CHART   |  | GENERAL MARKET           |  | 2 OF 2       |  |