

PLEASE CHECK WWW.MOLEX.COM FOR LATEST PART INFORMATION

Part Number: **0191930034**
Status: **Active**
Overview: VersaKrimp Terminals and Splices
Description: VersaKrimp Ring Tongue Terminal for 18-22 AWG Wire

Documents:

Drawing (PDF)	Product Specification PS-19902-013-001 (PDF)
Product Specification PS-19902-011-001 (PDF)	RoHS Certificate of Compliance (PDF)

Agency Certification

CSA	LR18689
UL	E32244

General

Product Family	Ring and Spade Terminals
Series	<u>19193</u>
Crimp Quality Equipment	Yes
Overview	<u>VersaKrimp Terminals and Splices</u>
Product Name	VersaKrimp
Taxonomy	Ring and Spade Terminals
Type	Ring
UPC	800755049046

Physical

Barrel Type	Closed - Brazed
Insulation	None
Material - Plating Mating	Tin
Net Weight	0.441/g
Packaging Type	Bag
Stud Size	5-6 (M3-3.5)
Wire Size AWG	18, 20, 22
Wire Size mm ²	0.35-0.80

Material Info

Engineering Number	AA-332-06
--------------------	-----------

Reference - Drawing Numbers

Product Specification	PS-19902-011-001, PS-19902-013-001
Sales Drawing	191930398-000

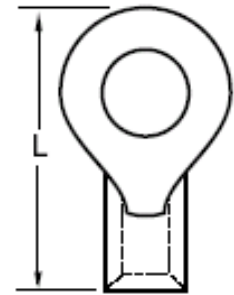

Series image - Reference only

EU ELV

Not Relevant

EU RoHS

Compliant

REACH SVHC

Not Contained Per -
D(2022)4187-DC (10
June 2022)

Halogen-Free

Status

Low-Halogen

For more information, please visit [Contact US](#)

China ROHS

ELV

RoHS Phthalates

China RoHS

Green Image

Not Relevant

Not Contained

Search Parts in this Series

19193 Series

Application Tooling | FAQ

Tooling specifications and manuals are found by selecting the products below. Crimp Height Specifications are then contained in the Application Tooling Specification document.

Global

Description	Product #
-------------	-----------

PremiumGrade	<u>640030100</u>
--------------	------------------

Hand Crimp Tool for
Krimptite/Versakrimp
Terminals and
Splices, 10-22
AWG and 6.0mm² -
0.5mm²

Crimp Head for the	<u>640070100</u>
--------------------	------------------

AT-200 Pneumatic
Hand Tool

ServiceGrade Hand	<u>640160038</u>
-------------------	------------------

Crimp Tool - Ratchet

This document was generated on 02/01/2023

PLEASE CHECK WWW.MOLEX.COM FOR LATEST PART INFORMATION