

42U SmartRack Co-Location Standard-Depth Rack Enclosure Cabinet - 2 separate compartments

MODEL NUMBER: SR42UBCL

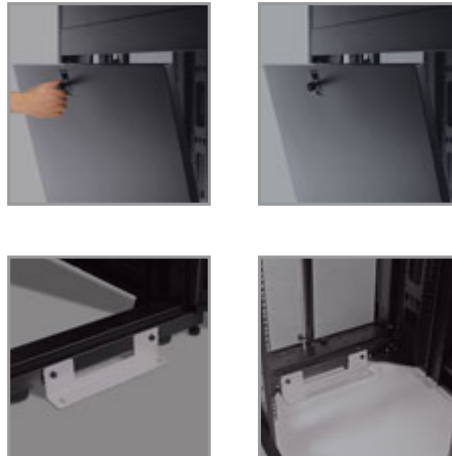

Features

- Ships fully assembled for rapid deployment and roll into place on heavy-duty pre-installed casters.
- Front and rear sets of equipment mounting rails adjust in 1/4" increments. Adjustment is quick and convenient. The easy-view depth index ensures consistent rail placement without requiring time-consuming measurements.
- Toolless accessory mounting rails (2 rails per enclosure) include slots for quick installation of compatible PDUs and vertical cable managers. Mounting slots are arranged in an industry-standard pattern compatible with a wide variety of accessories. Each rail can accommodate two vertical PDUs or cable managers side-by-side (four items per enclosure).
- Enclosure includes mounting hardware of 50 pieces of M6 cage nuts and 50 pieces of M6 screws
- Textured powder coat finish for tough resistance to environmental concerns such as deployment in warehouses.
- Massive front to rear ventilation capacity. 65+% open space in door perforation pattern meets or exceeds server manufacturer requirements.
- Maximum usable internal depth of 37 inches/94 cm (front to rear rail).
- Weight ratings of 3000 lbs (1360.8 kgs) stationary and 2250 lbs (1020.6 kgs) rolling.
- Front door is locking, reversible and removable.
- Secure cable channel, prevents other users from tampering with cables
- Rear doors are locking and reversible.
- Locking removable side panels are 'half size' to make them smaller and lighter improving ease of installation and servicing. Two side panels per side (4 panels total). Side panels are keyed alike to the front and rear doors.
- Built in baying tabs allow enclosures to be combined securely in rows. Center-to-center width can be set at 600mm or 24" to match standard data center floor tiles.
- Casters are pre-installed and support a rolling load capacity of 2250 lbs (1020.6 kgs), allowing the enclosures to be pre-configured and rolled to the final installation location. Casters are removable.
- Leveling feet extend to allow enclosure to be positioned on uneven floors. Levelers are removable.
- Compact design allows the enclosure to roll through standard height commercial doorways.

Highlights

- Two compartment co-location rack with doors and side panels
- 4 interior vertical posts with unthreaded square hole openings
- Standard 24" width for optimizing floor space
- Features a secure cable channel for each individual compartment
- Ships fully assembled
- Massive front to rear ventilation capacity
- 3000 lbs (1360.8 kgs) stationary / 2250 lbs (1020.6 kgs) rolling load capacity
- Locking, removable, reversible front and rear doors
- Combination lock, with key override standard on all doors
- Locking, removable side panels keyed alike with doors
- Meets all enclosure requirements towards PCI DSS (Payment Card Industry Data Security Standard) Compliance



- Convenient grounding system. All components are grounded to the enclosure frame which includes multiple connections for facility ground. Front and rear doors include quick-release ground wires.
- Open bottom for cable access.
- Top panel has generous cable access holes. Panel can be removed toollessly in seconds without having to disconnect cables first.
- Included stabilizing brackets are used for shipment and can be reattached at the bottom of the enclosure frame on the inside or outside of the rack.
- Meets all enclosure requirements towards PCI DSS (Payment Card Industry Data Security Standard) Compliance
- Compatibility with airflow optimization accessories as well as cable management accessories.

Specifications

| OVERVIEW | |
|---------------------------------|------------------------------------------|
| UPC Code | 037332147585 |
| Device Compatibility | Patch Panel; Network Switch; UPS; Server |
| Rack Type | Enclosure |
| PHYSICAL | |
| Color | Black |
| Rack Height | 42U |
| Rack Depth | Standard |
| Factory Preset Rack Depth (in.) | 27.75 |
| Factory Preset Rack Depth (cm) | 70.5 |
| Factory Preset Rack Depth (mm) | 705 |
| Maximum Device Depth (cm) | 93.98 |
| Maximum Device Depth (in.) | 37 |
| Maximum Device Depth (mm) | 940 |
| Minimum Device Depth (cm) | 10.16 |
| Minimum Device Depth (in.) | 4 |
| Minimum Device Depth (mm) | 102 |
| Shipping Dimensions (hwd / in.) | 85.00 x 26.00 x 45.50 |
| Shipping Dimensions (hwd / cm) | 215.90 x 66.04 x 115.57 |
| Shipping Weight (lbs.) | 341.00 |
| Shipping Weight (kg) | 154.67 |
| Unit Dimensions (hwd / in.) | 78.500 x 23.630 x 43.000 |
| Unit Dimensions (hwd / cm) | 199.39 x 60.02 x 109.22 |
| Unit Weight (lbs.) | 305 |



| | |
|--------------------------------------|----------------------------|
| Unit Weight (kg) | 138.35 |
| Weight Capacity - Rolling (kg) | 1,021 |
| Weight Capacity - Rolling (lbs.) | 2250 |
| Weight Capacity - Stationary (kg) | 1,361 |
| Weight Capacity - Stationary (lbs.) | 3000 |
| Number of Vertical Mounting Rails | 4 |
| FEATURES & SPECIFICATIONS | |
| Grounding Lug | Front and back door frames |
| Built-in Cable Management | Yes |
| STANDARDS & COMPLIANCE | |
| Product Certifications | UL 60950-1 |
| Product Compliance | RoHS; CE (Europe) |
| WARRANTY & SUPPORT | |
| Product Warranty Period (Worldwide) | 5-year limited warranty |

© 2022 Tripp Lite. All rights reserved. All product and company names are trademarks or registered trademarks of their respective holders. Use of them does not imply any affiliation with or endorsement by them. Tripp Lite has a policy of continuous improvement. Specifications are subject to change without notice.

Tripp Lite uses primary and third-party agencies to test its products for compliance with standards. See a list of Tripp Lite's testing agencies:

<https://www.tripplite.com/products/product-certification-agencies>