

DESCRIPTION: MALE - CRIMP AND LOAD

****NOTE: CONTACTS MUST BE PURCHASED SEPARATELY****

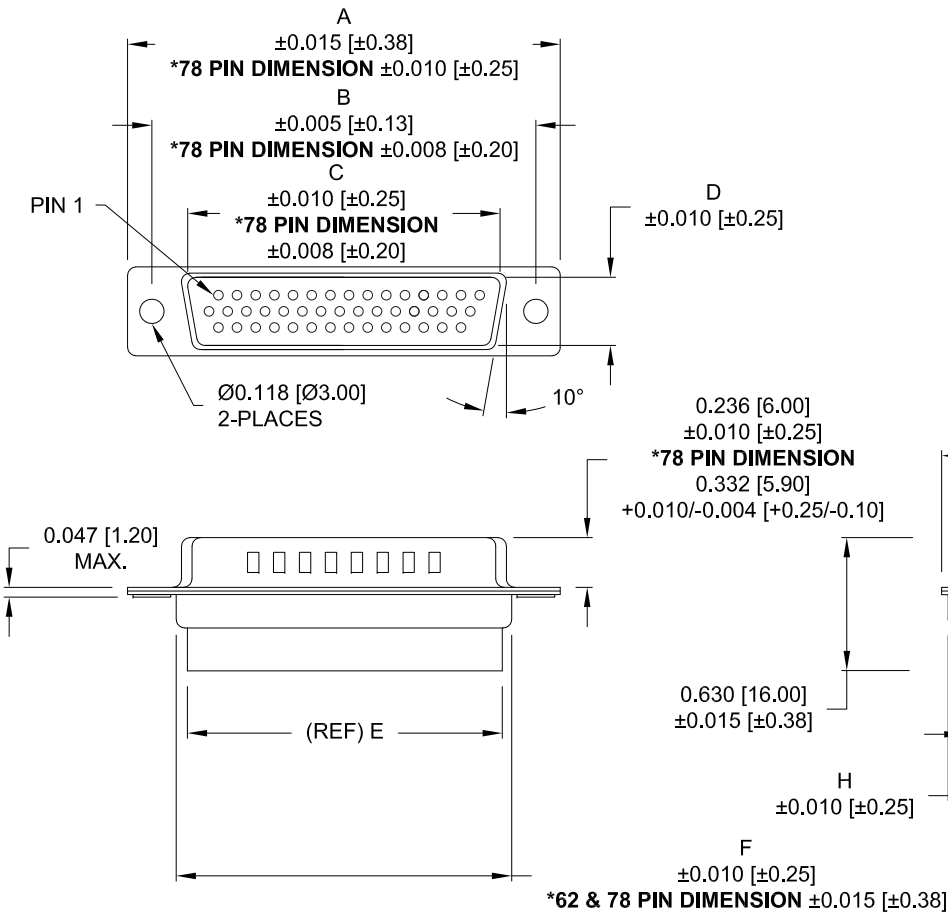

4 ROWS

		DIMENSIONS							
No. OF PINS		A	B	C	D	E	F	G	H
15		1.213	0.984	0.666	0.323	0.610	0.759	0.494	0.421
		30.81	24.99	16.92	8.20	15.50	19.28	12.55	10.70
26		1.541	1.312	0.994	0.323	0.964	1.083	0.494	0.421
		39.14	33.32	25.25	8.20	24.50	27.51	12.55	10.70
44		2.088	1.852	1.534	0.323	1.494	1.618	0.494	0.421
		53.04	47.04	38.96	8.20	37.95	41.10	12.55	10.70
62		2.729	2.500	2.182	0.319	2.142	2.272	0.494	0.421
		69.32	63.50	55.42	8.10	54.40	57.71	12.55	10.70
78		2.644	2.406	2.081	0.439	2.035	2.169	0.605	0.527
		67.16	61.11	52.86	11.15	51.70	55.10	15.37	13.40

180-YYY-17YLYY0

SERIES _____
 POSITIONS _____
 015
 026
 044
 062
 078
 GENDER _____
 1 = MALE
 TERMINATION _____
 7 = CRIMP & LOAD
 SHELL PLATING _____
 2 = TIN (DISCONTINUED)
 3 = NICKEL (GROUND INDENTS)
 RoHS COMPLIANT (230°C) _____
 HARDWARE OPTIONS _____
 00 = NO HARDWARE
 01 = .157" CLINCH NUT (SOLDER SIDE)
 02 = .250" CLINCH NUT (SOLDER SIDE)
 03 = .250" CLINCH NUT (MATING SIDE)
 PLATING OPTIONS _____
 0 = NO CONTACTS

MATERIAL:

SHELL: NICKEL PLATED STEEL
 INSULATOR: PBT +30% GF, UL 94 V-0

ELECTRICAL:

INSULATION RESISTANCE: 1,000 MOhms MIN.
 VOLTAGE: 500VAC FOR 1 MINUTE
 TEMPERATURE: -50° C TO 100° C

UNITS = inch[mm]

DO NOT SCALE FROM DRAWING



THESE DRAWINGS AND SPECIFICATIONS ARE THE PROPERTY OF NorComp AND SHALL NOT BE REPRODUCED, COPIED OR USED AS THE BASIS FOR THE MANUFACTURE OF SALE OF APPARATUS WITHOUT WRITTEN PERMISSION.

DRAWN:	DATE:
J KADEL	07-16-18

NorComp

SCALE:	SHEET	OF	REV
NTS	1	2	22
DWG NO. 180-YYY-17YLYY0			

RoHS COMPLIANT

ALL CLINCH-NUTS ARE 4-40 INTERNAL THREADS

UNITS = inch[mm]

TOLERANCE:
ALL DIMENSIONS ARE ±0.010

01X 0.157" (SOLDER SIDE)

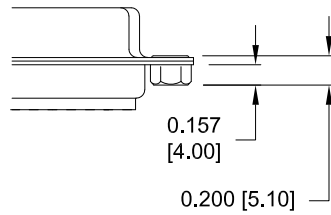

02X 0.250" (SOLDER SIDE)

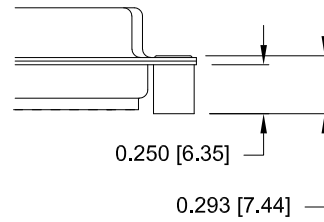

03X..... 0.250" (MATING SIDE)

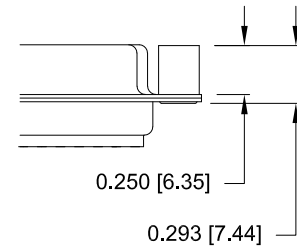

DO NOT SCALE FROM DRAWING



THESE DRAWINGS AND SPECIFICATIONS ARE THE PROPERTY OF NorComp AND SHALL NOT BE REPRODUCED, COPIED OR USED AS THE BASIS FOR THE MANUFACTURE OF SALE OF APPARATUS WITHOUT WRITTEN PERMISSION.

DRAWN:
J KADEL

DATE:
07-16-18

NorComp

SCALE: NTS	SHEET 2	OF 2	REV 22
---------------	------------	---------	-----------

DWG NO. 180-YYY-17YLYY0

RoHS COMPLIANT